

NOTES

1. SEE TC-01 FOR SIGN DESCRIPTION. ALL WARNING SIGNS SHALL HAVE A BLACK LEGEND AND BORDER ON AN ORANGE BACKGROUND UNLESS OTHERWISE SPECIFIED.
2. SEE TC-02 FOR SIGN AND DELINEATOR SPACING, TAPER AND BUFFER LENGTHS. SIGN SPACING MAY BE INCREASED AND DELINEATOR SPACING MAY DECREASE FROM THE DISTANCES SHOWN IN THE TABLE BASED ON SITE SPECIFIC CONDITIONS (DRIVEWAYS, SIDE STREETS, ETC.).
3. THIS PLAN DOES NOT APPLY TO SIGNALIZED OR MULTI-WAY STOP LOCATIONS.
4. "SHOULDER WORK" SIGN MAY BE SUBSTITUTED WITH A "ROAD WORK AHEAD" OR "UTILITY WORK AHEAD" SIGN AS CONDITIONS APPLY.
5. COMBINE THIS DRAWING DETAIL WITH OTHERS AS NEEDED TO COMPLETE TEMPORARY TRAFFIC CONTROL FOR EACH WORK ACTIVITY.
6. SHARROWS MAY BE CONSIDERED FOR TEMPORARY INSTALLATION ON ROADWAYS WITH A POSTED SPEED LIMIT OF 35 MPH OR LESS AT THE DISCRETION OF THE ACHD TRAFFIC ENGINEER. SHARROWS SHALL BE INSTALLED ACCORDING TO ACHD STANDARD DRAWING TS-1113.05, OR AS DIRECTED BY THE ACHD TRAFFIC ENGINEER. TEMPORARY SHARROW MARKINGS SHALL BE OBLITERATED UPON COMPLETION OF THE WORK.
7. IF APPLICABLE, SIGNS INSTALLED IN ADVANCE OF AND INCLUDING THE BIKE LANE CLOSURE NOTIFICATION SHALL BE LOCATED OUTSIDE OF THE BICYCLE LANE OR BICYCLE TRAVEL PATH. THIS MAY NECESSITATE POST MOUNTED SIGN INSTALLATION. OTHER SIGNS MAY BE INSTALLED ON PORTABLE STANDS SUBJECT TO OTHER TTC REGULATIONS.
8. "BIKE MAY USE FULL LANE" SIGN SHALL BE MOUNTED ABOVE DELINEATORS SO VEHICLE OR BICYCLE SIGN VISION IS NOT OBSTRUCTED.

LEGEND

	DELINEATOR		SHARROW
	SIGN		ARROW BOARD
	FLAGGER		WORK AREA
	BARRICADE		TRAFFIC DIRECTION
	VARIABLE MESSAGE SIGN		

POSTED SPEED LIMIT (MPH)	SHOULDER TAPER LENGTH (L)	DELINEATOR SPACING (TAPER/TAN.)	SIGN SPACING	BUFFER LENGTH	SHARROWS Y/N?
		/			

NO.	DATE	BY	DESCRIPTION



• REVISIONS •			
Drawn By	Shirley NIS	Checked By	Shirley NIS
Design By	Shirley NIS	Approved By	ACHD
Date	01/23/2017	File	TC-150.DWG

• TYPICAL TRAFFIC CONTROL PLAN •
Bicycle Traffic Control
Bike Lane Closure for Shoulder Work

• STANDARD DETAIL NO. •
TC-150

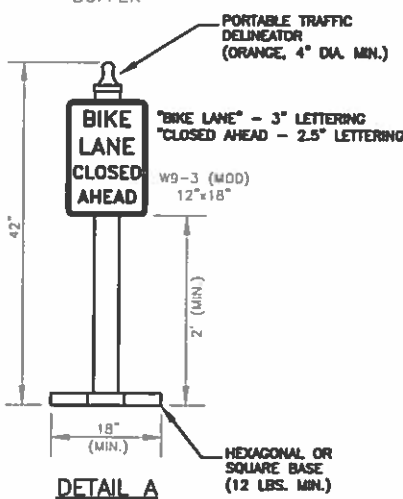
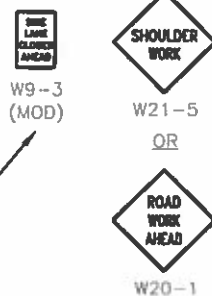
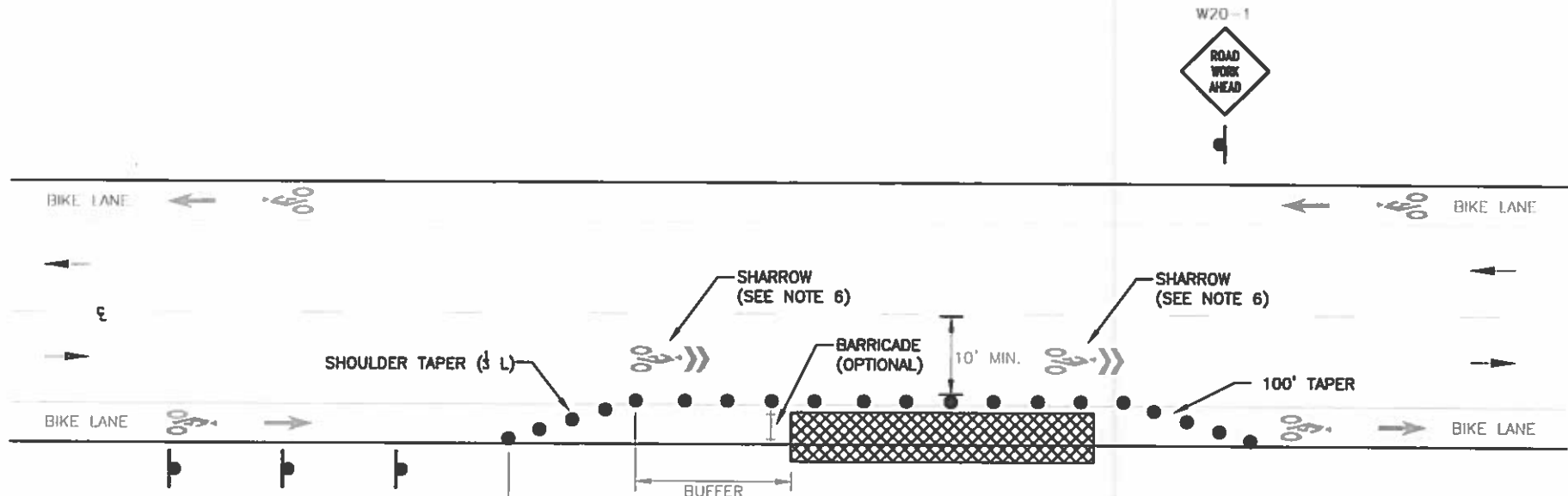

NOTES

- SEE TC-01 FOR SIGN DESCRIPTION. ALL WARNING SIGNS SHALL HAVE A BLACK LEGEND AND BORDER ON AN ORANGE BACKGROUND UNLESS OTHERWISE SPECIFIED.
- SEE TC-02 FOR SIGN AND DELINEATOR SPACING, TAPER AND BUFFER LENGTHS. SIGN SPACING MAY BE INCREASED AND DELINEATOR SPACING MAY DECREASE FROM THE DISTANCES SHOWN IN THE TABLE BASED ON SITE SPECIFIC CONDITIONS (DRIVEWAYS, SIDE STREETS, ETC.).
- THIS PLAN DOES NOT APPLY TO SIGNALIZED OR MULTI-WAY STOP LOCATIONS.
- "SHOULDER WORK" SIGN MAY BE SUBSTITUTED WITH A "ROAD WORK AHEAD" OR "UTILITY WORK AHEAD" SIGN AS CONDITIONS APPLY.
- COMBINE THIS DRAWING DETAIL WITH OTHERS AS NEEDED TO COMPLETE TEMPORARY TRAFFIC CONTROL FOR EACH WORK ACTIVITY.
- SHARROWS MAY BE CONSIDERED FOR TEMPORARY INSTALLATION ON ROADWAYS WITH A POSTED SPEED LIMIT OF 35 MPH OR LESS AT THE DISCRETION OF THE ACHD TRAFFIC ENGINEER. SHARROWS SHALL BE INSTALLED ACCORDING TO ACHD STANDARD DRAWING TS-1113.05, OR AS DIRECTED BY THE ACHD TRAFFIC ENGINEER. TEMPORARY SHARROW MARKINGS SHALL BE OBLITERATED UPON COMPLETION OF THE WORK.
- IF APPLICABLE, ALL SIGNS INSTALLED IN ADVANCE OF AND INCLUDING THE "BIKE LANE CLOSED AHEAD" SIGN SHALL BE LOCATED OUTSIDE OF THE BICYCLE LANE OR BICYCLE TRAVEL PATH. THIS MAY NECESSITATE POST MOUNTED SIGN INSTALLATION. OTHER SIGNS MAY BE INSTALLED ON PORTABLE STANDS SUBJECT TO OTHER TTC REGULATIONS.
- "BIKE LANE MAY USE FULL LANE" SIGN SHALL BE MOUNTED ABOVE DELINEATORS SO VEHICLE OR BICYCLE SIGN VISION IS NOT OBSTRUCTED.
- THIS TTC IS APPLICABLE TO MOBILE, SHORT DURATION AND INTERMEDIATE-TERM STATIONARY WORK (THREE DAYS OR LESS). WORK THAT EXCEEDS THREE DAYS SHOULD CONSIDER POST MOUNTED SIGNS IN ADVANCE OF THE WORK AREA SUBJECT TO ACHD REVIEW.

NOTES

- IF USED, THE PORTABLE "BIKE LANE CLOSED AHEAD" SIGN MAY BE PLACED IN THE BIKE LANE, ASSUMING THERE IS AT LEAST FOUR (4) FEET OF BIKE LANE REMAINING, AS MEASURED FROM THE CENTERLINE OF STRIPE TO THE EDGE OF THE SIGN BASE.
- IF USED, THE PORTABLE "BIKE LANE CLOSED AHEAD" SIGN MAY BE PLACED IN THE ADJACENT SIDEWALK, ASSUMING THERE IS AT LEAST FOUR (4) FEET OF SIDEWALK AVAILABLE FOR PEDESTRIAN TRAVEL.
- ADDITIONAL BALLAST SUPPORT MAY BE ADDED TO THE SIGN BASED, SUBJECT TO THE AFOREMENTIONED PROVISIONS RELATED TO AVAILABLE BICYCLE AND PEDESTRIAN SPACE.
- SEE TC-1500 FOR FURTHER DETAILS REGARDING TEMPORARY SIGN PLACEMENT IN THE TRAVEL WAY.

POSTED SPEED LIMIT (MPH)	SHOULDER TAPER LENGTH (1/2 L)	DELINEATOR SPACING (TAPER/TAN.)	SIGN SPACING	BUFFER LENGTH	SHARROWS Y/N?
		/			

LEGEND

	DELINEATOR		SHARROW
	SIGN		ARROW BOARD
	FLAGGER		WORK AREA
	BARRICADE		TRAFFIC DIRECTION
	VARIABLE MESSAGE SIGN		

REVISIONS

NO.	DATE	BY	DESCRIPTION



DESIGNER

Drawn By: Jeffrey Seab	Design By: Jeffrey Seab
Date: 03/13/2017	Approved By: ACHD
File: TC-150A.DWG	

TYPICAL TRAFFIC CONTROL PLAN

Bicycle Traffic Control
Bike Lane Closure for Shoulder Work, Short Duration

STANDARD SERIAL NO.

TC-150A

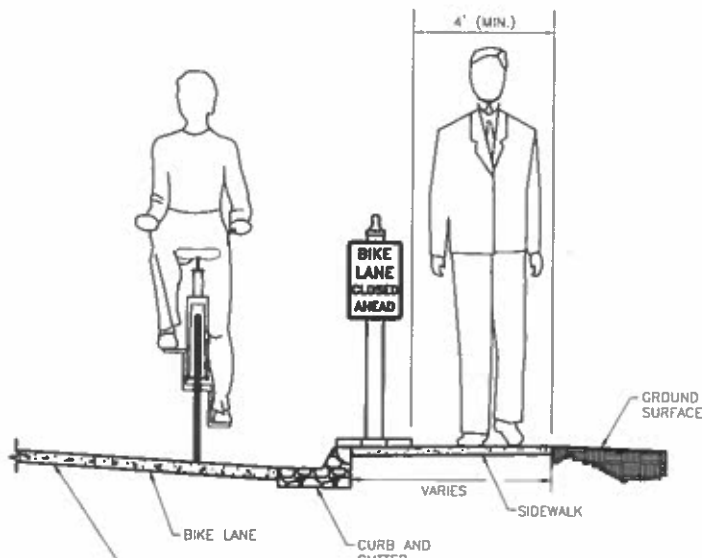

CLEARANCE REQUIREMENT FOR PORTABLE SIGN PLACED ON SIDEWALK

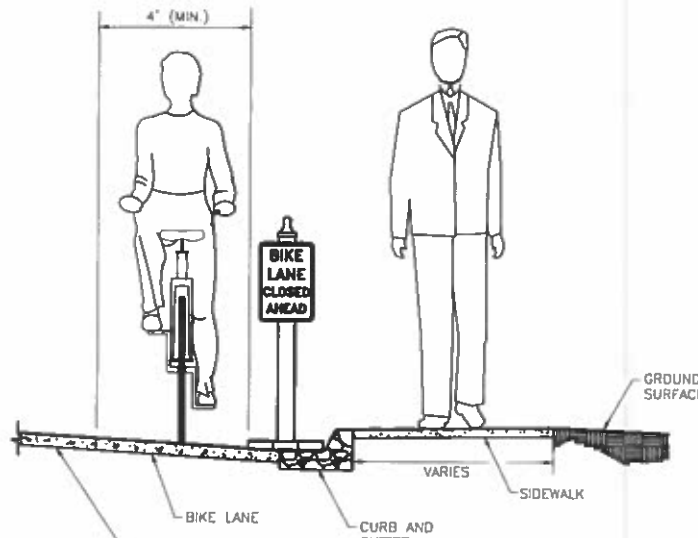

CLEARANCE REQUIREMENT FOR PORTABLE SIGN PLACED IN BIKE LANE

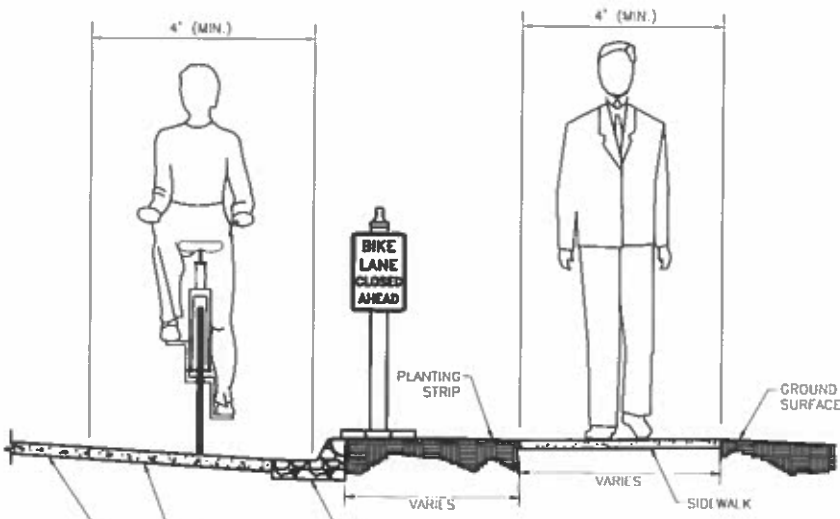
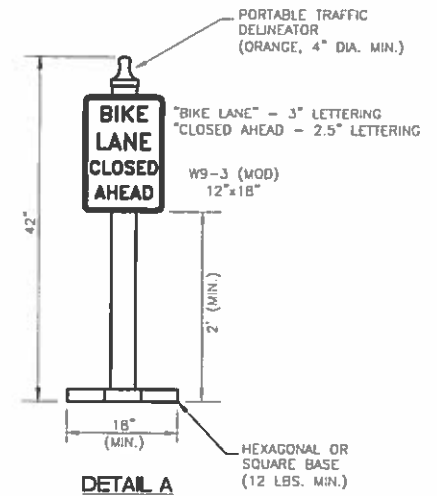

CLEARANCE REQUIREMENT FOR PORTABLE SIGN PLACED IN PLANTING STRIP

NOTES

1. IF USED, THE PORTABLE "BIKE LANE CLOSED AHEAD" SIGN MAY BE PLACED IN THE BIKE LANE, ASSUMING THERE IS AT LEAST FOUR (4) FEET OF BIKE LANE REMAINING, AS MEASURED FROM THE CENTERLINE OF STRIPE TO THE EDGE OF THE SIGN BASE.
2. IF USED, THE PORTABLE "BIKE LANE CLOSED AHEAD" SIGN MAY BE PLACED IN THE ADJACENT SIDEWALK, ASSUMING THERE IS AT LEAST FOUR (4) FEET OF SIDEWALK AVAILABLE FOR PEDESTRIAN TRAVEL.
3. IF USED, THE PORTABLE "BIKE LANE CLOSED AHEAD" SIGN MAY BE PLACED IN THE ADJACENT PLANTING STRIP, PROVIDED THE PLANTING STRIP IS IN ACHD RIGHT OF WAY AND DEVICE VISIBILITY IS NOT COMPROMISED BY NEARBY VEGETATION.
4. ADDITIONAL BALLAST SUPPORT MAY BE ADDED TO THE SIGN BASE, SUBJECT TO THE AFOREMENTIONED PROVISIONS RELATED TO AVAILABLE BICYCLE AND PEDESTRIAN SPACE.
5. RETROREFLECTIVE STRIPS SHALL BE REQUIRED IF TEMPORARY SIGNS ARE TO BE INSTALLED IN THE TRAVEL WAY AND TURNED AWAY FROM TRAFFIC OVERNIGHT. THE STRIPS SHALL BE PLACED ON THE SIGN POST AND BACK SUCH THAT THEY ARE VISIBLE TO ONGOING TRAFFIC IN THE DIRECTION THE SIGN IS TURNED (INSTALLED ON THE BACK OF THE POST IF THE SIGN IS TURNED 180 DEGREES FROM TRAFFIC, E.G.), THE COLOR OF THE STRIP RELATIVE TO THE CLASS OF SIGN SHALL BE AS FOLLOWS:

REGULATORY - RED OR WHITE
 WARNING - YELLOW
 CONSTRUCTION - ORANGE

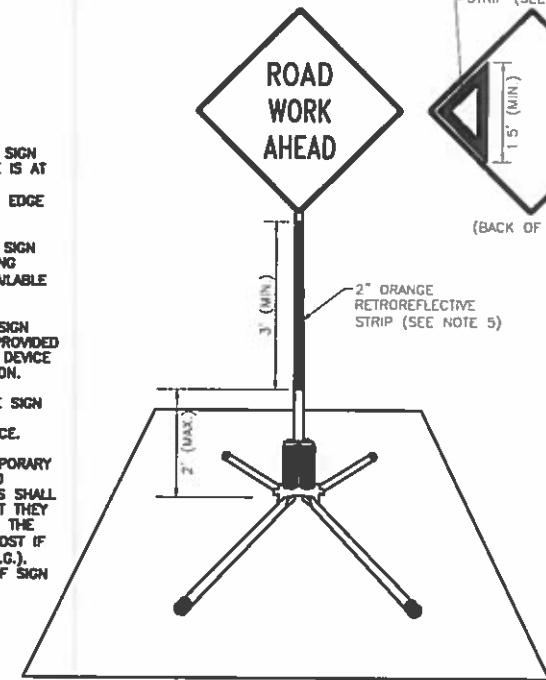
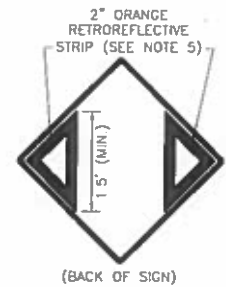

RETROREFLECTIVITY DETAIL

NO.	DATE	BY	DESCRIPTION
1	12/2017	JCS	Added retroreflectivity detail
2			
3			
4			



REVISIONS			
NO.	DATE	BY	DESCRIPTION
1	07/23/2017	JCS	Added retroreflectivity detail
2			
3			
4			

TYPICAL TRAFFIC CONTROL PLAN
 Bicycle Traffic Control
 Short Duration Bike Lane Impedance

STANDARD DETAIL NO.
TC-150B

W20-1

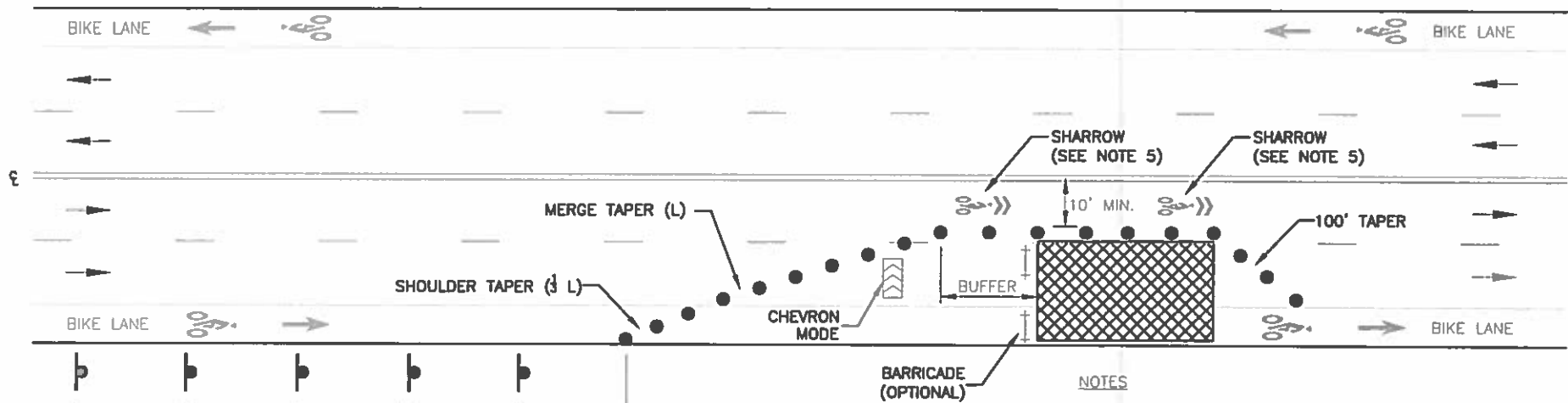

NOTES

1. SEE TC-01 FOR SIGN DESCRIPTION. ALL WARNING SIGNS SHALL HAVE A BLACK LEGEND AND BORDER ON AN ORANGE BACKGROUND UNLESS OTHERWISE SPECIFIED.
2. SEE TC-02 FOR SIGN AND DELINEATOR SPACING, TAPER AND BUFFER LENGTHS. SIGN SPACING MAY BE INCREASED AND DELINEATOR SPACING MAY DECREASE FROM THE DISTANCES SHOWN IN THE TABLE BASED ON SITE SPECIFIC CONDITIONS (DRIVEWAYS, SIDE STREETS, ETC.).
3. THIS PLAN DOES NOT APPLY TO SIGNALIZED OR MULTI-WAY STOP LOCATIONS.
4. THE ARROW BOARD SHOULD BE LOCATED INSIDE THE MERGE TAPER BEHIND THE CHANNELIZING DEVICES AS CLOSE TO THE BEGINNING OF THE MERGE TAPER AS FEASIBLE.
5. SHARROWS MAY BE CONSIDERED FOR TEMPORARY INSTALLATION ON ROADWAYS WITH A POSTED SPEED LIMIT OF 35 MPH OR LESS AT THE DISCRETION OF THE ACHD TRAFFIC ENGINEER. SHARROWS SHALL BE INSTALLED ACCORDING TO ACHD STANDARD DRAWING TS-1113.05, OR AS DIRECTED BY THE ACHD TRAFFIC ENGINEER. TEMPORARY SHARROW MARKINGS SHALL BE OBLITERATED UPON COMPLETION OF THE WORK.
6. IF APPLICABLE, ALL SIGNS INSTALLED IN ADVANCE OF AND INCLUDING THE BIKE LANE CLOSURE NOTIFICATION SHALL BE LOCATED OUTSIDE OF THE BIKE LANE OR BICYCLE TRAVEL PATH. THIS MAY NECESSITATE POST MOUNTED SIGN INSTALLATION. OTHER SIGNS MAY BE INSTALLED ON PORTABLE STANDS SUBJECT TO OTHER TTC REGULATIONS.
7. "BIKE MAY USE FULL LANE" SIGN SHALL BE MOUNTED ABOVE DELINEATORS SO VEHICLE OR BICYCLE SIGN VISION IS NOT OBSTRUCTED.



LEGEND

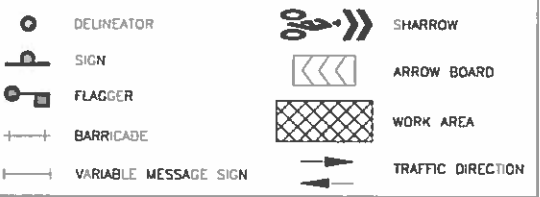

POSTED SPEED LIMIT (MPH)	MERGE TAPER LENGTH (L)	SHOULDER TAPER LENGTH (S L)	DELINEATOR SPACING (TAPER/TAN.)	SIGN SPACING	BUFFER LENGTH	SHARROWS Y/N?
			/			

NO.	DATE	BY	DESCRIPTION



• REVISIONS •			

• DISAPPROVED •			

• TYPICAL TRAFFIC CONTROL PLAN •		• DRAWING SCALE NO. •
Bicycle Traffic Control Bike Lane with Right Lane Closure		TC-151

WORK ZONE SIGNAGE

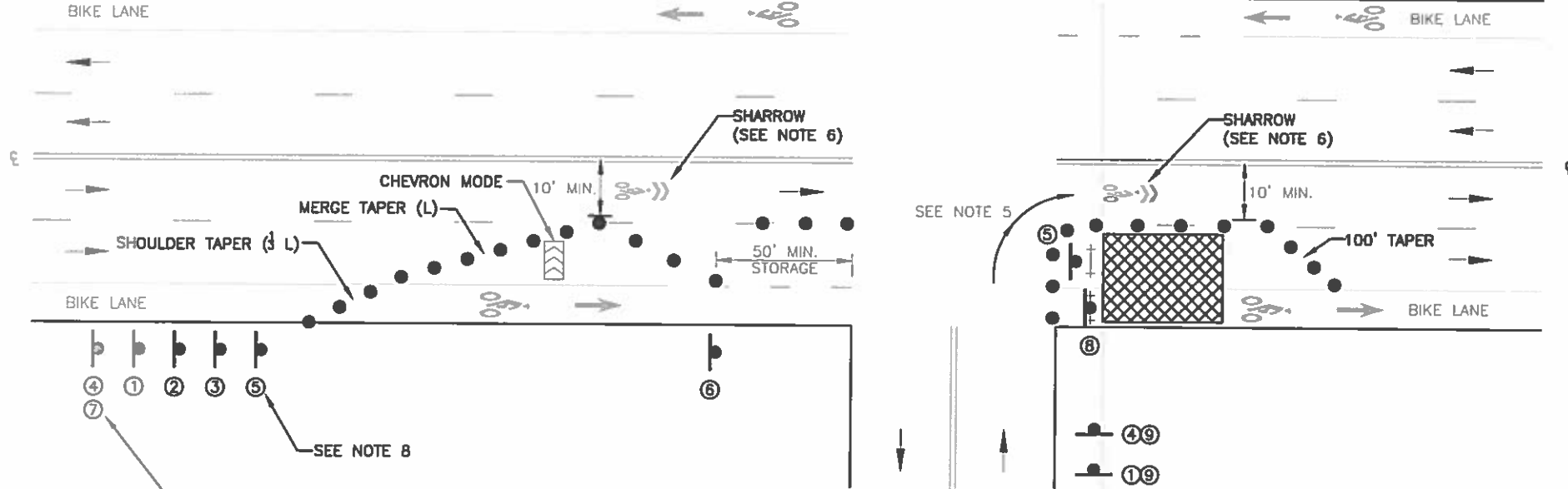
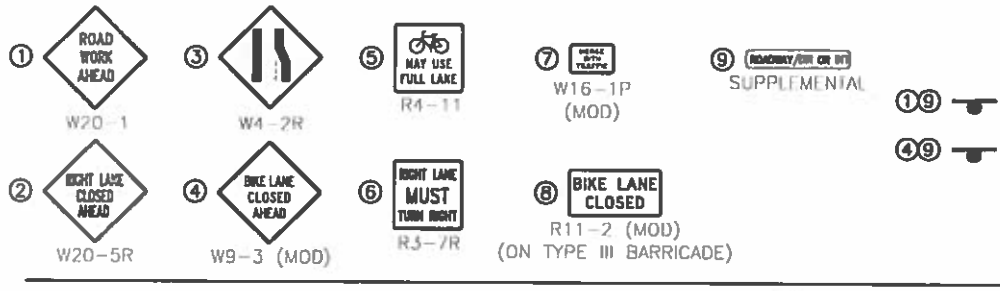

NOTES

- SEE TC-01 FOR SIGN DESCRIPTION. ALL WARNING SIGNS SHALL HAVE A BLACK LEGEND AND BORDER ON AN ORANGE BACKGROUND UNLESS OTHERWISE SPECIFIED.
- SEE TC-02 FOR SIGN AND DELINEATOR SPACING, TAPER AND BUFFER LENGTHS. SIGN SPACING MAY BE INCREASED AND DELINEATOR SPACING MAY DECREASE FROM THE DISTANCES SHOWN IN THE TABLE BASED ON SITE SPECIFIC CONDITIONS (DRIVEWAYS, SIDE STREETS, ETC.).
- CONTRACTOR SHALL MAINTAIN ALL APPLICABLE INTERSECTION CONTROL SIGNS, INCLUDING BUT NOT LIMITED TO STOP SIGNS, LANE USE CONTROL SIGNS AND TRAFFIC SIGNALS.
- THE ARROW BOARD SHOULD BE LOCATED INSIDE THE MERGE TAPER BEHIND THE CHANNELIZING DEVICES AS CLOSE TO THE BEGINNING OF THE MERGE TAPER AS FEASIBLE.
- RIGHT TURN RESTRICTIONS ON THE SIDE STREET MAY BE NECESSARY DEPENDING ON SITE SPECIFIC WORK CONDITIONS.
- SHARROWS MAY BE CONSIDERED FOR TEMPORARY INSTALLATION ON ROADWAYS WITH A POSTED SPEED LIMIT OF 35 MPH OR LESS AT THE DISCRETION OF THE ACHD TRAFFIC ENGINEER. SHARROWS SHALL BE INSTALLED ACCORDING TO ACHD STANDARD DRAWING TS-1113.05, OR AS DIRECTED BY THE ACHD TRAFFIC ENGINEER. TEMPORARY SHARROW MARKINGS SHALL BE OBLITERATED UPON COMPLETION OF THE WORK.
- IF APPLICABLE, SIGNS INSTALLED IN ADVANCE OF AND INCLUDING THE BIKE LANE CLOSURE NOTIFICATION SHALL BE LOCATED OUTSIDE OF THE BICYCLE LANE OR BICYCLE TRAVEL PATH. THIS MAY NECESSITATE POST MOUNTED SIGN INSTALLATION. OTHER SIGNS MAY BE INSTALLED ON PORTABLE STANDS SUBJECT TO OTHER TTC REGULATIONS.
- "BIKE MAY USE FULL LANE" SIGN SHALL BE MOUNTED ABOVE DELINEATORS SO VISIBILITY IS NOT OBSTRUCTED FOR MOTORISTS AND BICYCLISTS.

POSTED SPEED LIMIT (MPH)	MERGE TAPER LENGTH (L)	SHOULDER TAPER LENGTH (3 L)	DELINEATOR SPACING	SIGN SPACING	BUFFER LENGTH	SHARROWS Y/N?

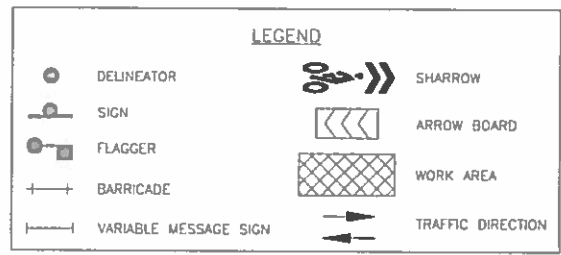

• REVISIONS •

NO.	DATE	BY	DESCRIPTION



• DRAWINGS •

Scale	Drawn By	Checked By
NTS	Su Min Engineering	Su Min Engineering
Date: 01/23/2017	Design By	Su Min Engineering
File: TC-152.DWG	Approved By	ACHD

• TYPICAL TRAFFIC CONTROL PLAN •

• STANDARD SYMBOL NO. •
Bicycle Traffic Control Bike Lane with Right Lane Closure on Far Side of Intersection
TC-152

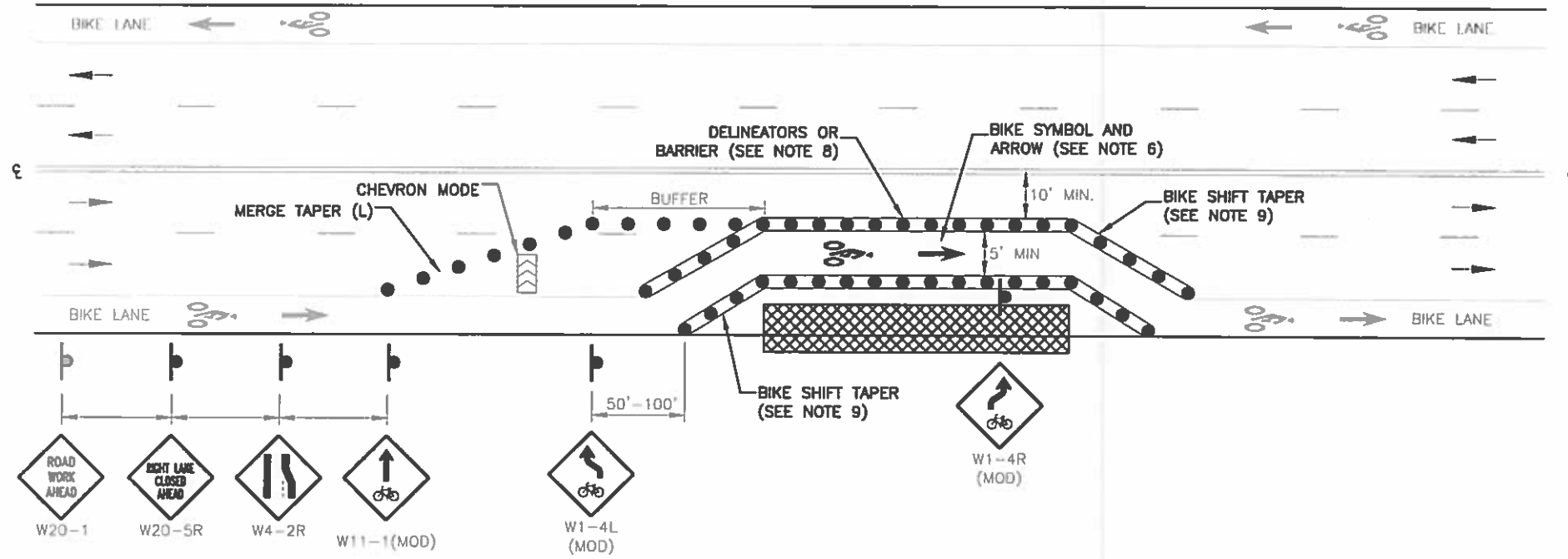

NOTES

- SEE TC-01 FOR SIGN DESCRIPTION. ALL WARNING SIGNS SHALL HAVE A BLACK LEGEND AND BORDER ON AN ORANGE BACKGROUND UNLESS OTHERWISE SPECIFIED.
- SEE TC-02 FOR SIGN AND DELINEATOR SPACING, TAPER AND BUFFER LENGTHS. SIGN SPACING MAY BE INCREASED AND DELINEATOR SPACING MAY DECREASE FROM THE DISTANCES SHOWN IN THE TABLE BASED ON SITE SPECIFIC CONDITIONS (DRIVEWAYS, SIDE STREETS, ETC.).
- THIS PLAN DOES NOT APPLY TO SIGNALIZED OR MULTI-WAY STOP LOCATIONS.
- THE ARROW BOARD SHOULD BE LOCATED INSIDE THE MERGE TAPER BEHIND THE CHANNELIZING DEVICES AS CLOSE TO THE BEGINNING OF THE MERGE TAPER AS FEASIBLE WITHOUT OBSTRUCTING THE BICYCLE TRAVEL PATH.
- COMBINE THIS DRAWING DETAIL WITH OTHERS AS NEEDED TO COMPLETE TEMPORARY TRAFFIC CONTROL FOR EACH WORK ACTIVITY.
- BIKE LANE SYMBOLS AND ARROWS MAY BE CONSIDERED FOR TEMPORARY INSTALLATION AT THE DISCRETION OF THE ACHD TRAFFIC ENGINEER. TEMPORARY BIKE LANE SYMBOLS AND ARROWS SHALL BE OBLITERATED UPON COMPLETION OF THE WORK.
- SIGNS INSTALLED IN ADVANCE OF AND INCLUDING THE BIKE LANE SHIFT NOTIFICATION SHALL BE LOCATED OUTSIDE OF THE BICYCLE LANE OR BICYCLE TRAVEL PATH. THIS MAY NECESSITATE POST MOUNTED SIGN INSTALLATION. OTHER SIGNS MAY BE INSTALLED ON PORTABLE STANDS SUBJECT TO OTHER TTC REGULATIONS.
- DELINEATORS WITH A MAXIMUM SPACING OF 20 FEET SHALL BE USED FOR BOTH SIDES OF THE BIKE SHIFT TAPER AND TANGENT. PORTABLE TRAFFIC BARRIER INSTALLATION AND CRASHWORTHY END TREATMENTS MAY BE REQUIRED ON HIGHER SPEED FACILITIES (40 MPH OR GREATER) AT THE DISCRETION OF THE ACHD TRAFFIC ENGINEER.
- BIKE SHIFT TAPER SHALL BE BASED ON THE SHOULDER TAPER LENGTH "1/3 L" FOR THE GIVEN BIKE LANE OFFSET AND A 20 MPH BICYCLE SPEED (SEE TC-02 FOR FORMULA).

LEGEND

- DELINEATOR
- ARROW BOARD
- ▬ SIGN
- ▬ FLAGGER
- ▬ BARRICADE
- ▬ VARIABLE MESSAGE SIGN
- ▬ PORTABLE TRAFFIC BARRIER
- ▬ WORK AREA
- ▬ TRAFFIC DIRECTION

POSTED SPEED LIMIT (MPH)	MERGE TAPER LENGTH (L)	BIKE SHIFT TAPER LENGTH (1/3 L)	DELINEATOR SPACING (TAPER/TAN.)	SIGN SPACING	BUFFER LENGTH
			/		

NO.	DATE	BY	DESCRIPTION



DESIGNED		DRAWN	
Drawn By		Drawn By	
Date	01/23/2017	Design By	
File	TC-153.DWG	Approved By	

• TYPICAL TRAFFIC CONTROL PLAN •

**Bicycle Traffic Control
Bike Lane Shift with Right Lane Closure**

• STANDARD DETAIL NO. •
TC-153

WORK ZONE SIGNAGE

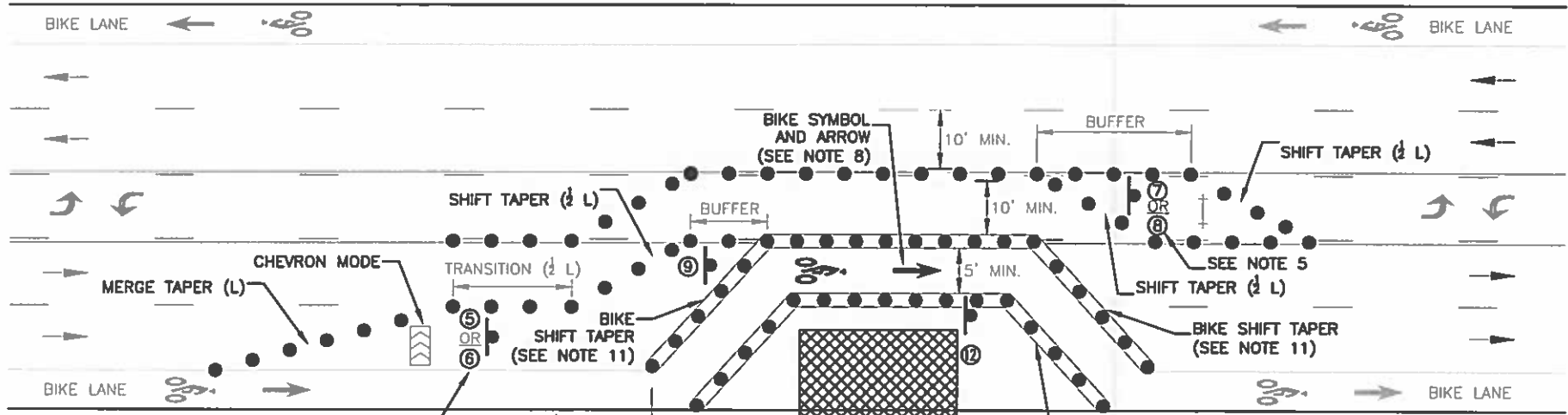
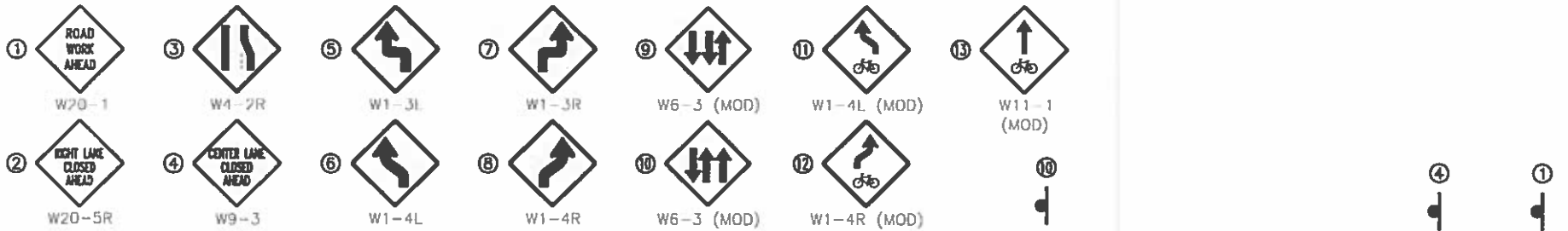

NOTES

- SEE TC-01 FOR SIGN DESCRIPTION. ALL WARNING SIGNS SHALL HAVE A BLACK LEGEND AND BORDER ON AN ORANGE BACKGROUND UNLESS OTHERWISE SPECIFIED.
- SEE TC-02 FOR SIGN AND DELINEATOR SPACING, TAPER AND BUFFER LENGTHS. SIGN SPACING MAY BE INCREASED AND DELINEATOR SPACING MAY DECREASE FROM THE DISTANCES SHOWN IN THE TABLE BASED ON SITE SPECIFIC CONDITIONS (DRIVEWAYS, SIDE STREETS, ETC.).
- THIS PLAN DOES NOT APPLY TO SIGNALIZED OR MULTI-WAY STOP LOCATIONS.
- THE ARROW BOARD SHOULD BE LOCATED INSIDE THE MERGE TAPER BEHIND THE CHANNELIZING DEVICES AS CLOSE TO THE BEGINNING OF THE MERGE TAPER AS FEASIBLE WITHOUT OBSTRUCTING THE BICYCLE TRAVEL PATH.
- THE W1-3R AND W1-3L SIGNS SHALL BE USED WHEN THE POSTED SPEED LIMIT IS 30 MPH OR LESS. THE W1-4R AND W1-4L SIGNS SHALL BE USED WHEN THE POSTED SPEED LIMIT IS 35 MPH OR ABOVE. WORK ZONE SPEED LIMIT REDUCTIONS SHALL BE IMPLEMENTED ONLY WITH APPROVAL OF THE ACHD TRAFFIC ENGINEER.
- ADDITIONAL W6-3 SIGNS MAY BE REQUIRED BASED ON THE LENGTH OF THE WORK ZONE AT THE DISCRETION OF THE ACHD TRAFFIC ENGINEER.
- COMBINE THIS DRAWING DETAIL WITH OTHERS AS NEEDED TO COMPLETE TEMPORARY TRAFFIC CONTROL FOR EACH WORK ACTIVITY.
- BIKE LANE SYMBOLS AND ARROWS MAY BE CONSIDERED FOR TEMPORARY INSTALLATION AT THE DISCRETION OF THE ACHD TRAFFIC ENGINEER. TEMPORARY BIKE LANE SYMBOLS AND ARROWS SHALL BE OBLITERATED UPON COMPLETION OF THE WORK.
- ALL SIGNS INSTALLED IN ADVANCE OF AND INCLUDING THE BIKE LANE SHIFT NOTIFICATION SHALL BE LOCATED OUTSIDE OF THE BICYCLE LANE OR BICYCLE TRAVEL PATH. THIS MAY NECESSITATE POST MOUNTED SIGN INSTALLATION. OTHER SIGNS MAY BE INSTALLED ON PORTABLE STANDS SUBJECT TO OTHER TTC REGULATIONS.
- DELINEATORS WITH A MAXIMUM SPACING OF 20 FEET SHALL BE USED FOR BOTH SIDES OF THE BIKE SHIFT TAPER AND TANGENT. PORTABLE TRAFFIC BARRIER INSTALLATION AND CRASHWORTHY END TREATMENTS MAY BE REQUIRED ON HIGHER SPEED FACILITIES (40 MPH OR GREATER) AT THE DISCRETION OF THE ACHD TRAFFIC ENGINEER.
- BIKE SHIFT TAPER SHALL BE BASED ON THE SHOULDER TAPER LENGTH "1/3 L" FOR THE GIVEN BIKE LANE OFFSET AND A 20 MPH BICYCLE SPEED (SEE TC-02 FOR FORMULA).

LEGEND

- DELINEATOR
- SIGN
- FLAGGER
- ⊕ BARRICADE
- VARIABLE MESSAGE SIGN
- PORTABLE TRAFFIC BARRIER
- ◀◀◀ ARROW BOARD
- ▨ WORK AREA
- ▶▶▶ TRAFFIC DIRECTION

POSTED SPEED LIMIT	MERGE TAPER LENGTH (L)	TRANSITION LENGTH (1/2 L)	SHIFT TAPER LENGTH (1/2 L)	SHOULDER TAPER LENGTH (1/2 L)	BIKE SHIFT TAPER LENGTH (1/3 L)	DELINEATOR SPACING (TAPER/TAN.)	SIGN SPACING	BUFFER LENGTH
						/		

NO.	DATE	BY	DESCRIPTION



• SIGNATURES •

Drawn By	See May Engineering
Design By	See May Engineering
Approved By	ACHD

• TYPICAL TRAFFIC CONTROL PLAN •
 Bicycle Traffic Control
 Bike Lane Shift with Right Lane and Center Lane Closure

• STANDARD DETAIL NO. •
 TC-154

POSTED SPEED LIMIT (MPH)	DELINEATOR SPACING (TAPER/TAN.)	SIGN SPACING	BUFFER LENGTH	SHARROWS Y/N?
	/			

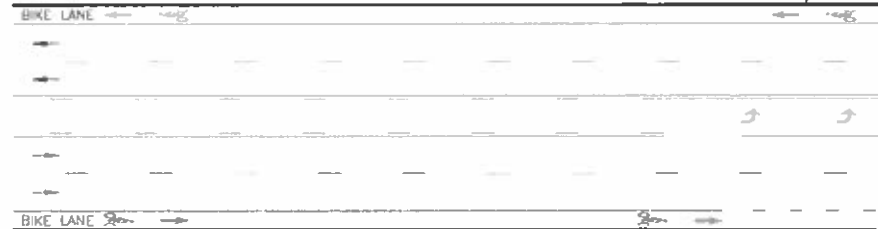
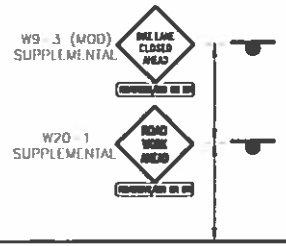

NOTES

- SEE TC-01 FOR SIGN DESCRIPTION. ALL WARNING SIGNS SHALL HAVE A BLACK LEGEND AND BORDER ON AN ORANGE BACKGROUND UNLESS OTHERWISE SPECIFIED.
- SEE TC-02 FOR SIGN AND DELINEATOR SPACING, TAPER AND BUFFER LENGTHS. SIGN SPACING MAY BE INCREASED AND DELINEATOR SPACING MAY DECREASE FROM THE DISTANCES SHOWN IN THE TABLE BASED ON SITE SPECIFIC CONDITIONS (DRIVEWAYS, SIDE STREETS, ETC.).
- "ROAD WORK AHEAD" SIGN MAY BE SUBSTITUTED WITH A "SHOULDER WORK" OR "UTILITY WORK AHEAD" SIGN AS CONDITIONS APPLY.
- SHARROWS MAY BE CONSIDERED FOR TEMPORARY INSTALLATION ON ROADWAYS WITH A POSTED SPEED LIMIT OF 35 MPH OR LESS AT THE DISCRETION OF THE ACHD TRAFFIC ENGINEER. SHARROWS SHALL BE INSTALLED ACCORDING TO ACHD STANDARD DRAWING TS-1113.05, OR AS DIRECTED BY THE ACHD TRAFFIC ENGINEER. TEMPORARY SHARROW MARKINGS SHALL BE OBLITERATED UPON COMPLETION OF THE WORK.
- "BIKES MAY USE FULL LANE" SIGNS MAY BE INSTALLED ALONG THE BIKE DETOUR ROUTE ON STREETS THAT DO NOT HAVE DESIGNATED BIKE FACILITIES AT THE DISCRETION OF THE ACHD TRAFFIC ENGINEER.
- IF APPLICABLE, SIGNS INSTALLED IN ADVANCE OF AND INCLUDING THE BIKE LANE CLOSURE NOTIFICATION OR WITHIN THE POSTED DETOUR ROUTE SHALL BE LOCATED OUTSIDE OF THE BICYCLE LANE OR BICYCLE TRAVEL PATH. THIS MAY NECESSITATE POST MOUNTED SIGN INSTALLATION. OTHER SIGNS MAY BE INSTALLED ON PORTABLE STANDS SUBJECT TO OTHER TTC REGULATIONS.

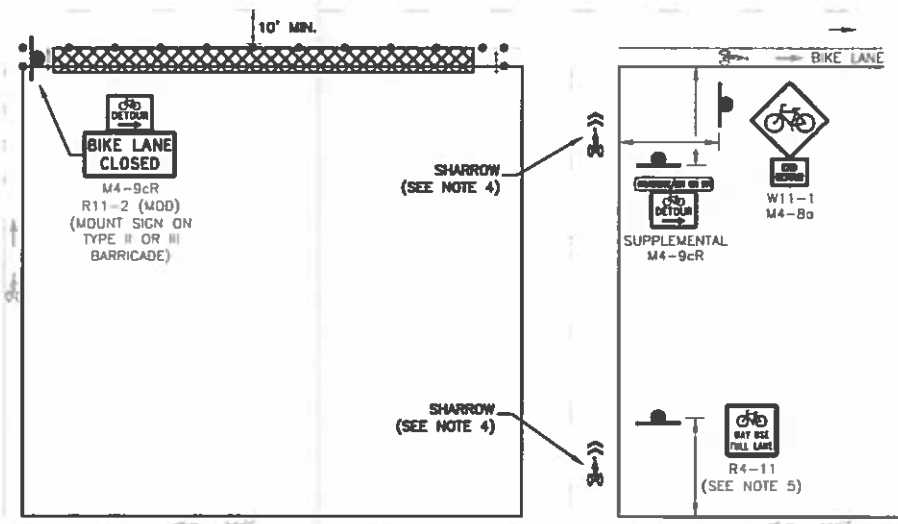
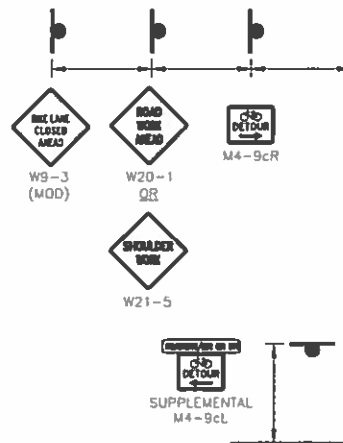

LEGEND

	DELINEATOR		SHARROW
	SIGN		ARROW BOARD
	FLAGGER		WORK AREA
	BARRICADE		TRAFFIC DIRECTION
	VARIABLE MESSAGE SIGN		

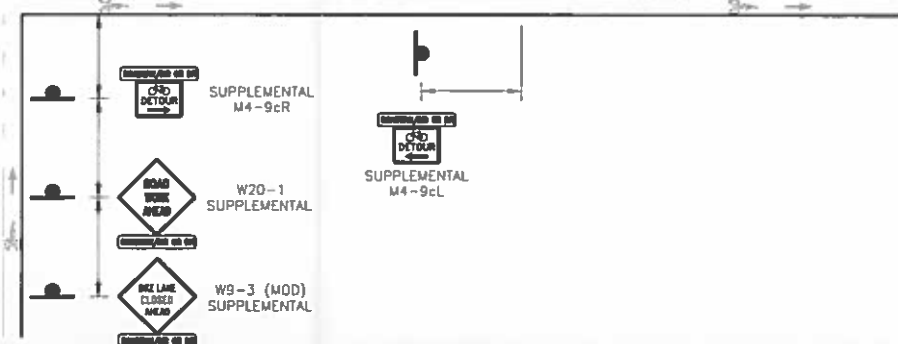

REV.	DATE	BY	DESCRIPTION



• DRAWN BY •			
Scale:	NTS	Drawn By:	Sia Mha Engineering
Date:	01/23/2017	Design By:	Sia Mha Engineering
File:	TC-155.DWG	Approved By:	ACHD

• TYPICAL TRAFFIC CONTROL PLAN •
 Bicycle Traffic Control
 Bike Lane Closure with Bike Detour

• SIGNING SHEET NO. •
TC-155

POSTED SPEED LIMIT (MPH)	SHIFT TAPER LENGTH (ft)	DELINEATOR SPACING (TAPER/TAN.)	SIGN SPACING	BUFFER LENGTH	SHARROWS Y/N?
		/			

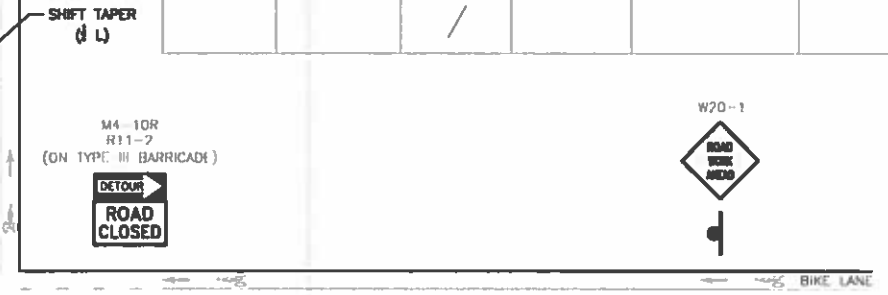

NOTES

- SEE TC-01 FOR SIGN DESCRIPTION. ALL WARNING SIGNS SHALL HAVE A BLACK LEGEND AND BORDER ON AN ORANGE BACKGROUND UNLESS OTHERWISE SPECIFIED.
- SEE TC-02 FOR SIGN AND DELINEATOR SPACING, TAPER AND BUFFER LENGTHS. SIGN SPACING MAY BE INCREASED AND DELINEATOR SPACING MAY DECREASE FROM THE DISTANCES SHOWN IN THE TABLE BASED ON SITE SPECIFIC CONDITIONS (DRIVEWAYS, SIDE STREETS, ETC.).
- INSTALL TEMPORARY TRAFFIC CONTROL DEVICES PER TC-155 IF THE BIKE DETOUR ROUTE DEVIATES FROM THE VEHICLE DETOUR ROUTE.
- SHARROWS MAY BE CONSIDERED FOR TEMPORARY INSTALLATION ON ROADWAYS WITH A POSTED SPEED LIMIT OF 35 MPH OR LESS AT THE DISCRETION OF THE ACHD TRAFFIC ENGINEER. SHARROWS SHALL BE INSTALLED ACCORDING TO ACHD STANDARD DRAWING TS-1113.05, OR AS DIRECTED BY THE ACHD TRAFFIC ENGINEER. TEMPORARY SHARROW MARKINGS SHALL BE OBLITERATED UPON COMPLETION OF THE WORK.
- ADDITIONAL TRAFFIC CONTROL SET UPS MAY BE REQUIRED FOR TURN LANE RESTRICTIONS DEPENDING ON SITE SPECIFIC CONDITIONS.
- "BIKES MAY USE FULL LANE" SIGNS MAY BE INSTALLED ALONG THE BIKE DETOUR ROUTE ON STREETS THAT DO NOT HAVE DESIGNATED BIKE FACILITIES AT THE DISCRETION OF THE ACHD TRAFFIC ENGINEER.

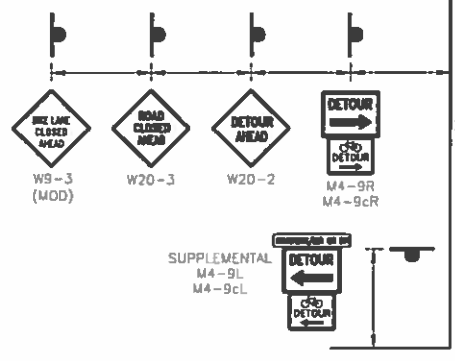

- IF APPLICABLE, SIGNS INSTALLED IN ADVANCE OF AND INCLUDING THE BIKE LANE CLOSURE NOTIFICATION OR WITHIN THE DETOUR ROUTE SHALL BE LOCATED OUTSIDE OF THE BICYCLE LANE OR BICYCLE TRAVEL PATH. THIS MAY NECESSITATE POST MOUNTED SIGN INSTALLATION. OTHER SIGNS MAY BE INSTALLED ON PORTABLE STANDS SUBJECT TO OTHER TTC REGULATIONS.

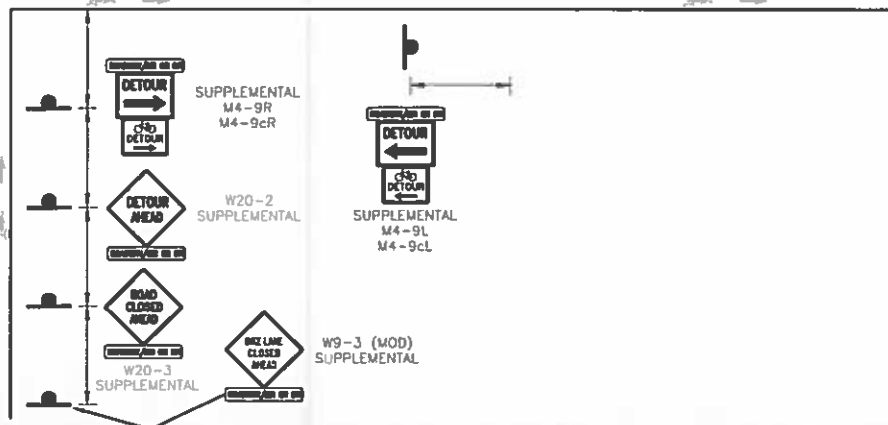
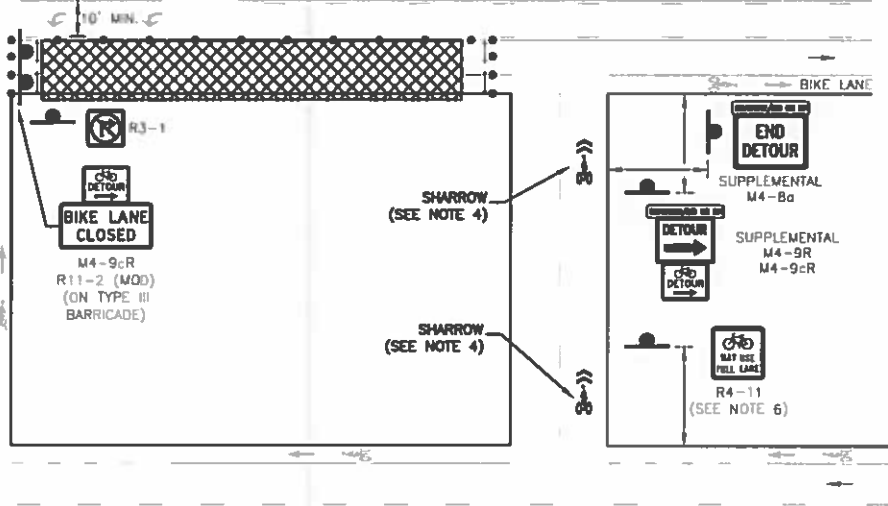

LEGEND

	DELINEATOR		SHARROW
	SIGN		ARROW BOARD
	FLAGGER		WORK AREA
	BARRICADE		TRAFFIC DIRECTION
	VARIABLE MESSAGE SIGN		

REVISIONS			
NO.	DATE	BY	DESCRIPTION



SUBMITTALS			
Scale:	NTS	Drawn By:	See Mile Engineering
Date:	01/23/2017	Design By:	See Mile Engineering
File:	TC-156.DWG	Approved By:	ACHD

TYPICAL TRAFFIC CONTROL PLAN
 Bicycle Traffic Control
 Vehicle and Bike Lane Detour

REVISIONS
 TC-156