

MERIDIAN ROAD AND MAIN STREET SPLIT CORRIDOR - PHASE I



ACHD PROJECT NO. 506040

MARCH 8, 2007

CONSTRUCTION PHASE 2



LEGEND

-  CONSTRUCTION WORK ZONE
-  THRU-LANE TRAVEL DIRECTION

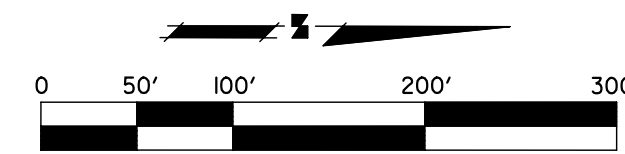

CONSTRUCTION PHASE 2 NOTES

- A** PHASE 2 CONSTRUCTS A TEMPORARY SIGNAL AT THE MERIDIAN/CORPORATE INTERSECTION TO ACCOMMODATE PHASE 2 TRAFFIC OPERATIONS.
- B** PHASE 2 MODIFIES THE EXISTING TRAFFIC SIGNALS AT THE MAIN/MERIDIAN, MAIN/CORPORATE, MAIN/FRANKLIN AND MERIDIAN/FRANKLIN INTERSECTIONS AS NECESSARY TO ACCOMMODATE PHASE 2 TRAFFIC OPERATIONS.
- C** PHASE 2 PLACES PAVEMENT MARKINGS AND SIGNING ON MERIDIAN ROAD AND MAIN STREET TO DEVELOP A ONE-WAY COUPLETT SOUTH OF FRANKLIN ROAD.
- D** PHASE 2 CONSTRUCTS WALTMAN LANE. ONE LANE OF TRAFFIC ON WALTMAN LANE MUST REMAIN OPEN TO LOCAL TRAFFIC AT ALL TIMES DURING PHASE 2 CONSTRUCTION. WALTMAN TRAFFIC SHALL BE ROUTED TO THE MERIDIAN/CORPORATE INTERSECTION FOR ACCESS TO MAIN STREET AND MERIDIAN ROAD.
- E** PHASE 2 CONSTRUCTS THE SOUTHBOUND LANES ON MERIDIAN ROAD. ONE LANE OF TRAFFIC MUST REMAIN OPEN FOR BUSINESS AND LOCAL ACCESS NORTH OF WALTMAN AT ALL TIMES DURING PHASE 2 CONSTRUCTION.
- F** PHASE 2 CONSTRUCTS THE WEST SIDE OF THE MEDIAN ISLAND AT THE MAIN/MERIDIAN INTERSECTION TO THE EXTENT THAT THE TRAFFIC SIGNAL POLE IN THE MEDIAN CAN BE INSTALLED. PHASE 2 ALSO CONSTRUCTS THE WEST PORTION OF THE MAIN/MERIDIAN TRAFFIC SIGNAL TO SERVE AS A TEMPORARY TRAFFIC SIGNAL FOR THE PHASE 3 AND PHASE 4 TRAFFIC OPERATIONS.
- G** PRIOR TO IMPLEMENTING THE PHASE 2 TRAFFIC OPERATIONS, THE PAVEMENT MARKINGS AND SIGNING FOR THE ONE-WAY COUPLETT (TASK C) AND THE NECESSARY TRAFFIC SIGNAL MODIFICATIONS TO ACCOMMODATE PHASE 2 TRAFFIC OPERATIONS (TASKS A AND B) SHALL BE COMPLETED. IN ADDITION, ALL OF THE PHASE 1 CONSTRUCTION SHALL BE COMPLETED, WITH THE EXCEPTION OF THE REMOVAL OF THE MAIN STREET LANDSCAPED MEDIAN ISLANDS. THE MEDIAN ISLANDS MAY BE REMOVED DURING PHASES 1, 2 OR 3.

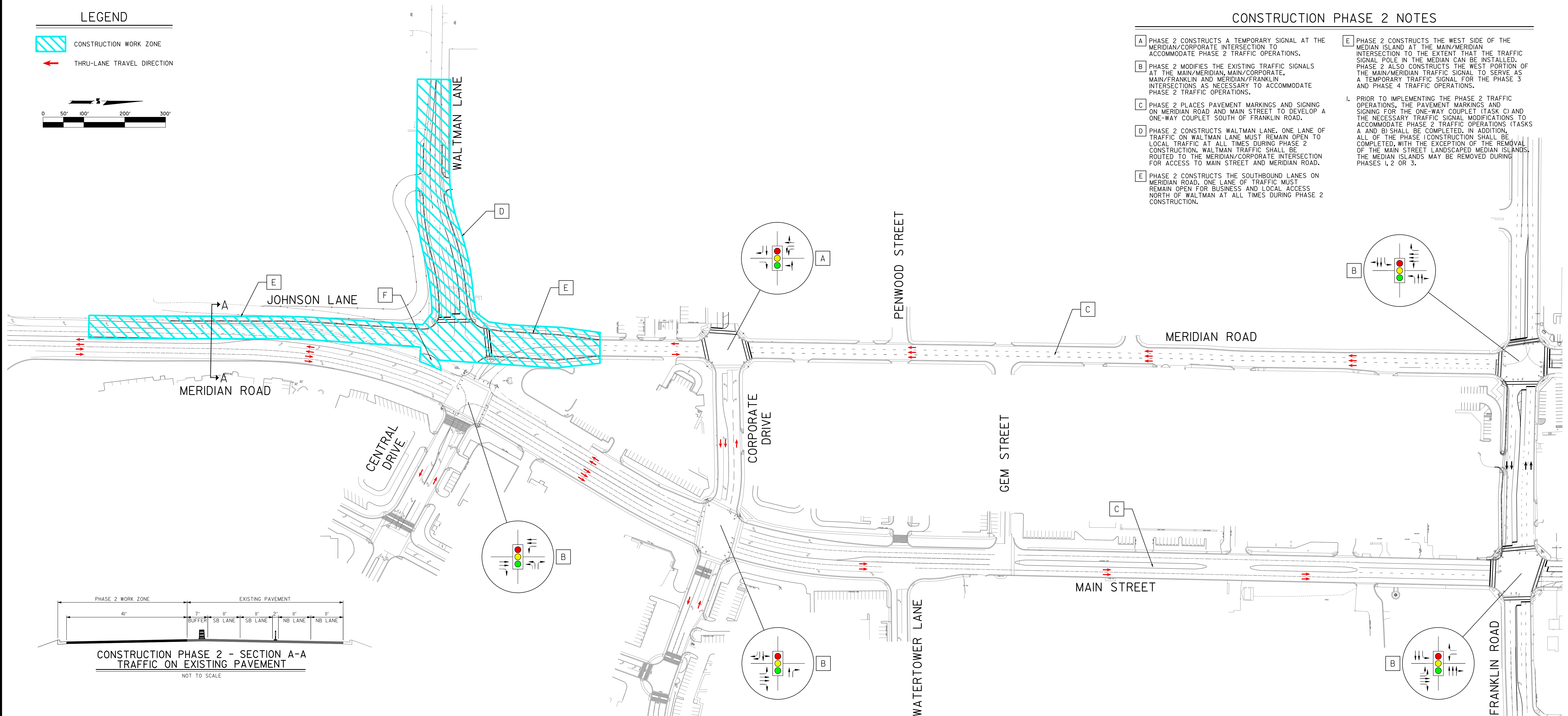

CONSTRUCTION PHASE 2 - SECTION A-A
TRAFFIC ON EXISTING PAVEMENT

NOT TO SCALE