

**NOTES:**

1. SPEED HUMPS SHALL NOT BE PLACED OVER MANHOLES, WATER VALVES, SURVEY MARKERS, ETC.
2. SPEED HUMPS SHALL NOT BE INSTALLED IN A LOCATION THAT INTERFERES WITH ROADWAY DRAINAGE.
3. A TACK COAT SHALL BE APPLIED TO THE ROADWAY SURFACE PRIOR TO APPLICATION OF PAVEMENT MATERIAL.
4. SPEED HUMP MARKINGS AND SIGNS SHALL BE INSTALLED BY ACHD, UNLESS OTHERWISE SPECIFIED BY THE ACHD TRAFFIC ENGINEER. MARKING INFORMATION FOR SPEED HUMPS CAN BE FOUND ON ACHD TS-1113.07.
5. "BUMPS AHEAD" SIGNS SHALL BE INSTALLED IN BOTH DIRECTIONS IN ADVANCE OF THE FIRST BUMP IN SERIES. SIGNS SHALL BE INSTALLED BY ACHD, UNLESS OTHERWISE SPECIFIED BY THE ACHD TRAFFIC ENGINEER.
6. IF CURB AND GUTTER ARE NOT PRESENT ON THE ROADWAY, INSTALL SPEED HUMPS TO THE EDGE OF THE PAVED SURFACE. 4" DIA. CONCRETE BOLLARD INSTALLATION NEAR THE SPEED HUMP MAY BE NECESSARY WHERE THE POTENTIAL FOR SPEED HUMP AVOIDANCE EXISTS.

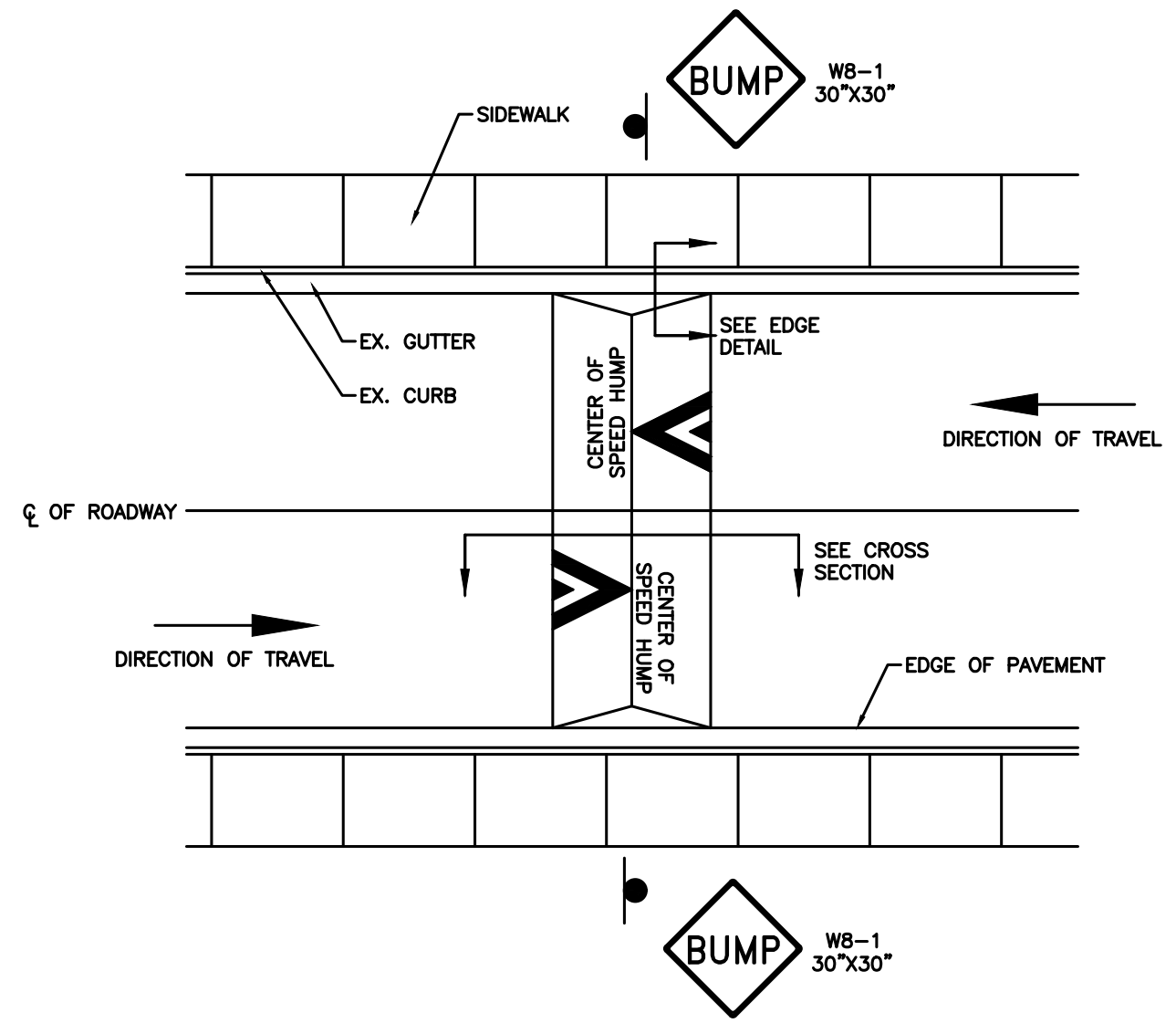

**SPEED HUMP - PLAN VIEW LOCAL ROAD**

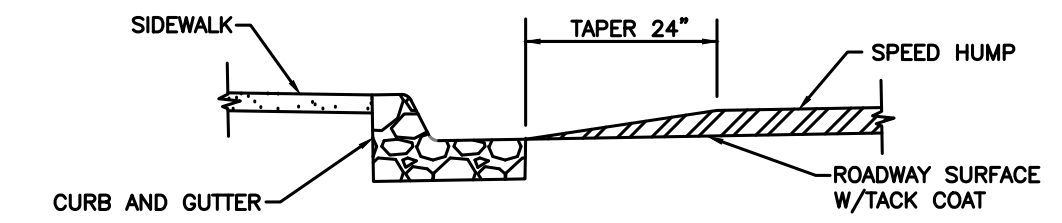

**SPEED HUMP - EDGE DETAIL LOCAL ROAD**

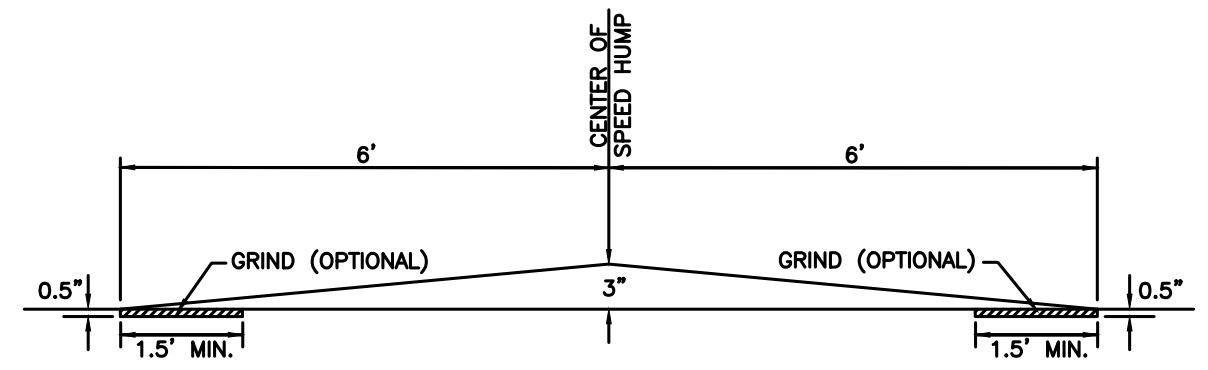

**SPEED HUMP - CROSS SECTION LOCAL ROAD**

NO.	DATE	BY	DESCRIPTION
1	11/2018	JES	Minor note clarifications



• SIGNATURES •	
Scale: NTS	Drawn By: Joshua Seak
Date: 06/30/2011	Design By: Joshua Seak
File: TS-1121.01.DWG	Approved By: Shawn Martin

• SHEET TITLE •
Speed Hump Details - Local Road

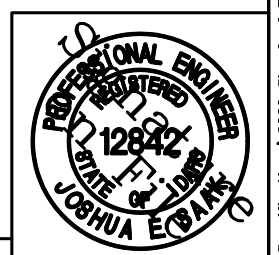

STANDARD DETAIL NO. TS-1121.01

s:\Traffic Specifications\2020 Standard Plans\ts-1121.01.DWG

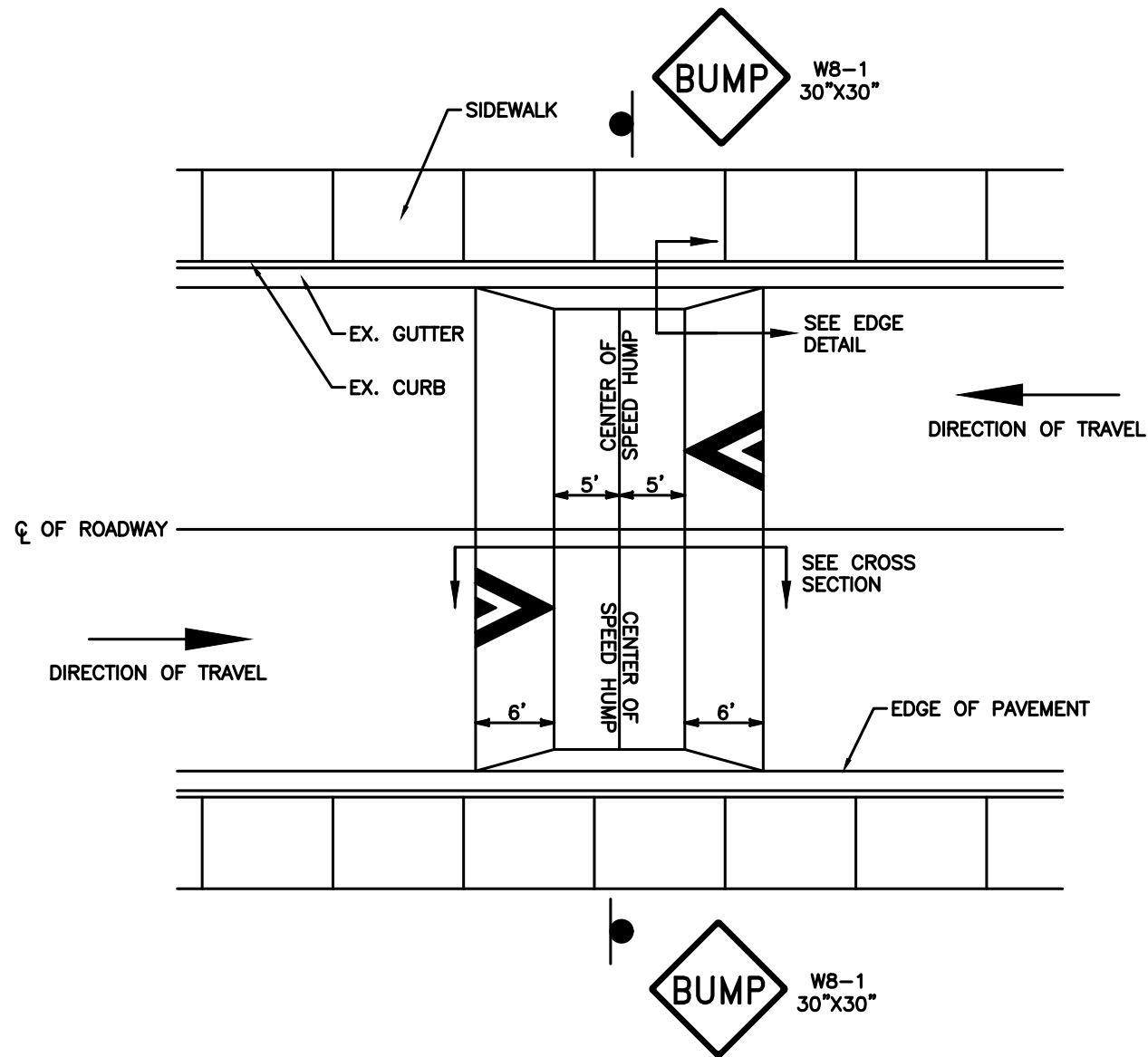

**SPEED HUMP - PLAN VIEW  
COLLECTOR ROAD**

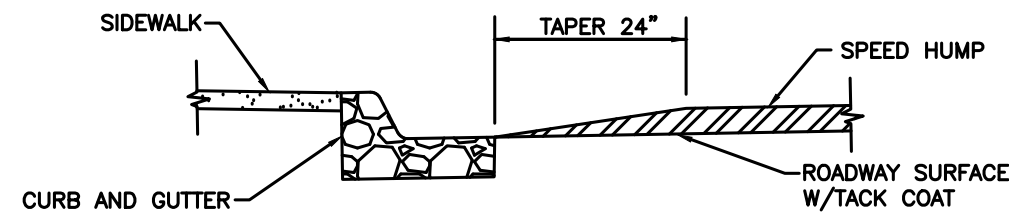

**SPEED HUMP - EDGE DETAIL  
COLLECTOR ROAD**

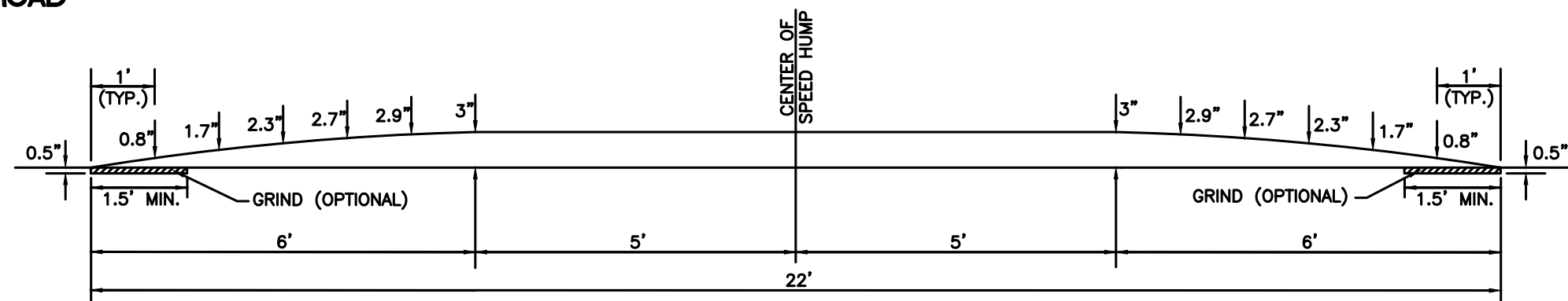

**SPEED HUMP - CROSS SECTION  
COLLECTOR ROAD**

**NOTES:**

1. SPEED HUMPS SHALL NOT BE PLACED OVER MANHOLES, WATER VALVES, SURVEY MARKERS, ETC.
2. SPEED HUMPS SHALL NOT BE INSTALLED IN A LOCATION THAT INTERFERES WITH ROADWAY DRAINAGE.
3. A TACK COAT SHALL BE APPLIED TO THE ROADWAY SURFACE PRIOR TO APPLICATION OF PAVEMENT MATERIAL.
4. SPEED HUMP MARKINGS AND SIGNS SHALL BE INSTALLED BY ACHD, UNLESS OTHERWISE SPECIFIED BY THE ACHD TRAFFIC ENGINEER. MARKING INFORMATION FOR SPEED HUMPS CAN BE FOUND ON ACHD TS-1113.07.
5. "BUMPS AHEAD" SIGNS SHALL BE INSTALLED IN BOTH DIRECTIONS IN ADVANCE OF THE FIRST BUMP IN SERIES. SIGNS SHALL BE INSTALLED BY ACHD, UNLESS OTHERWISE SPECIFIED BY THE ACHD TRAFFIC ENGINEER.
6. IF CURB AND GUTTER IS NOT PRESENT ON THE ROADWAY, INSTALL SPEED HUMPS TO THE EDGE OF THE PAVED SURFACE. 4" DIA. CONCRETE BOLLARD INSTALLATION NEAR THE SPEED HUMP MAY BE NECESSARY WHERE THE POTENTIAL FOR SPEED HUMP AVOIDANCE EXISTS.

NO.	DATE	BY	DESCRIPTION
11/2018	JES		Minor note clarifications
• REVISIONS •			

**ACHD**  
Traffic Engineering Division  
3775 Adams Street Boise, ID 83714  
www.achdidaho.org

• SIGNATURES •		• SHEET TITLE •	
Scale: NTS	Drawn By: Joshua Seak	Speed Hump Details - Collector Road	
Date: 07/01/2011	Design By: Joshua Seak		
File: TS-1121.02.DWG	Approved By: Shawn Martin		

PROFESSIONAL ENGINEER  
REGISTERED  
12842  
STATE OF IDAHO  
JOSHUA SEAK  
TS-1121.02  
STANDARD DETAIL NO.  
TS-1121.02

### SPEED HUMP DIMENSION SCHEDULE

A, ROADWAY WIDTH (FT.)	Y, EDGE (FT.)	Z, HUMPS (FT.)	X, CENTER GAP (FT.)	Z, HUMPS (FT.)	Y, EDGE (FT.)
20'	1.5'	7'	3'	7'	1.5'
21'	2'	7'	3'	7'	2'
22'	2.5'	7'	3'	7'	2.5'
23'	3'	7'	3'	7'	3'
24'	3'	7'	4'	7'	3'

**NOTES:**

1. SPEED HUMPS SHALL NOT BE PLACED OVER MANHOLES, WATER VALVES, SURVEY MARKERS, ETC.
2. SPEED HUMPS SHALL NOT BE INSTALLED IN A LOCATION THAT INTERFERES WITH ROADWAY DRAINAGE.
3. A TACK COAT SHALL BE APPLIED TO THE ROADWAY SURFACE PRIOR TO APPLICATION OF PAVEMENT MATERIAL.
4. SPEED HUMP MARKINGS AND SIGNS SHALL BE INSTALLED BY ACHD, UNLESS OTHERWISE SPECIFIED BY THE ACHD TRAFFIC ENGINEER. MARKING INFORMATION FOR SPEED HUMPS CAN BE FOUND ON ACHD TS-1113.07.
5. "BUMPS AHEAD" SIGNS SHALL BE INSTALLED IN BOTH DIRECTIONS IN ADVANCE OF THE FIRST BUMP IN SERIES. SIGNS SHALL BE INSTALLED BY ACHD, UNLESS OTHERWISE SPECIFIED BY THE ACHD TRAFFIC ENGINEER.
6. IF CURB AND GUTTER IS NOT PRESENT OR A SIGNIFICANT DRIVABLE SHOULDER EXISTS ON THE ROADWAY, 4" DIA. CONCRETE BOLLARD INSTALLATION NEAR EACH SPEED HUMP MAY BE NECESSARY WHERE THE POTENTIAL FOR SPEED HUMP AVOIDANCE EXISTS.

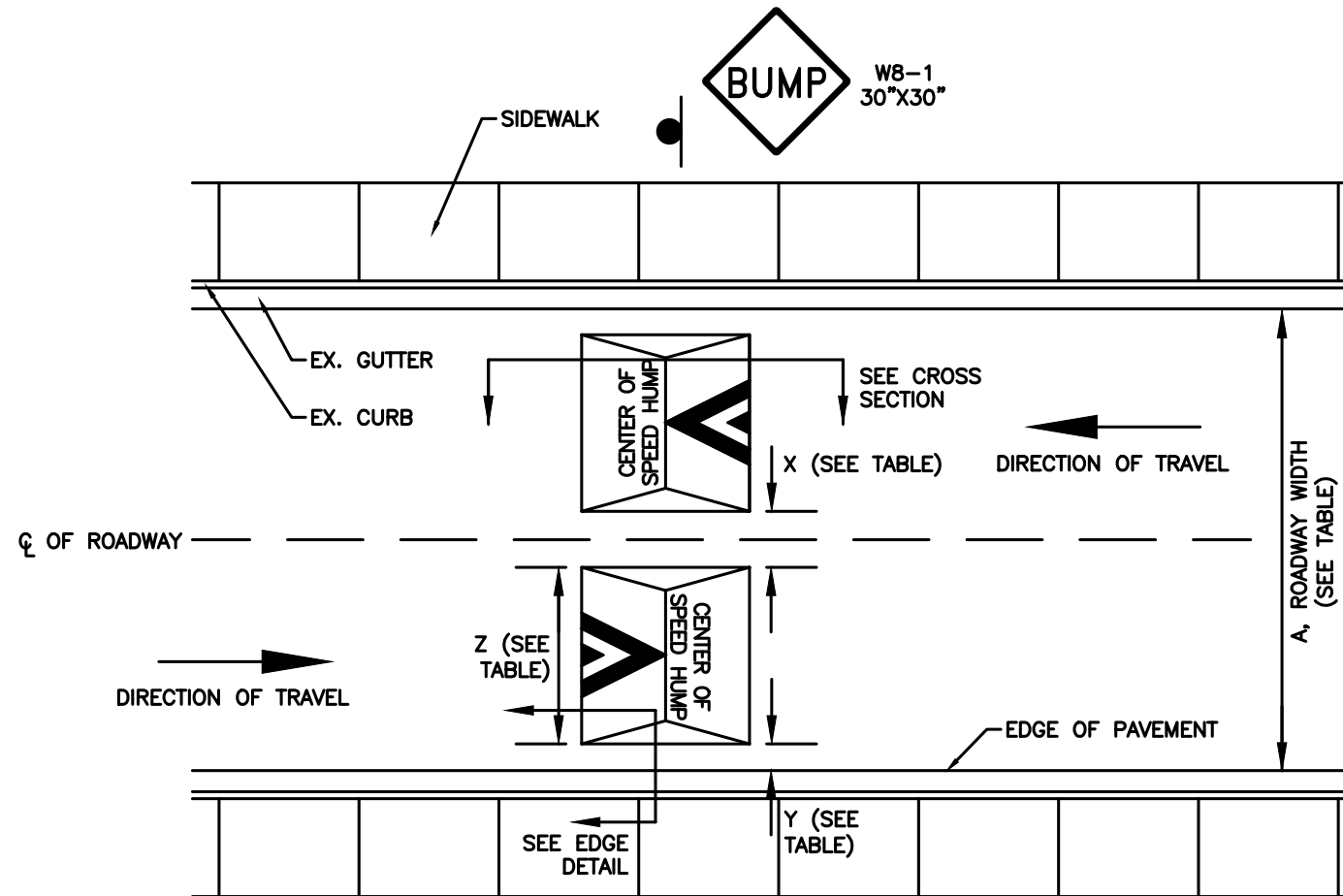

**SPEED CUSHIONS - PLAN VIEW  
LOCAL/COLLECTOR STREET**

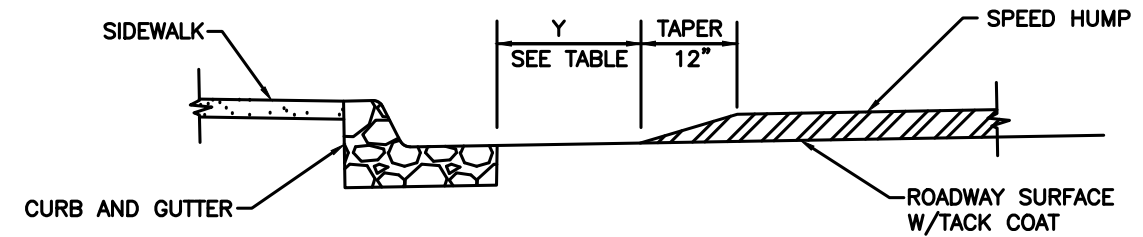

**SPEED CUSHIONS - EDGE DETAIL  
LOCAL/COLLECTOR STREET**

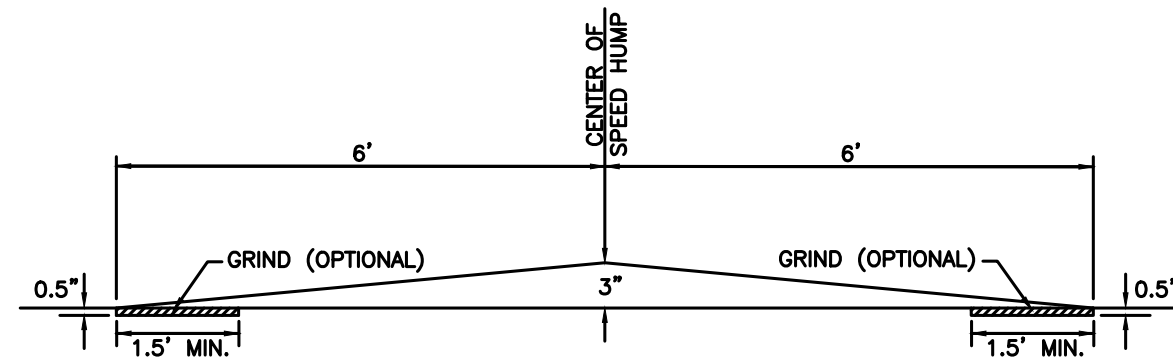

**SPEED CUSHIONS - CROSS SECTION  
LOCAL/COLLECTOR STREET**

NO.	DATE	BY	DESCRIPTION
• REVISIONS •			

**ACHD**  
Traffic Engineering Division  
3775 Adams Street Boise, ID 83714  
www.achdidaho.org

• SIGNATURES •		• SHEET TITLE •	
Scale: NTS	Drawn By: Joshua Seak	Speed Hump Details - Local/Collector Streets, Speed Cushions Roadway Cross Sections, 20' - 24'	
Date: 4/9/2012	Design By: Joshua Seak		
File: TS-1121.03.DWG	Approved By: Shawn Martin		

PROFESSIONAL ENGINEER  
REGISTERED  
12842  
STATE OF IDAHO  
JOSHUA SEAK  
STANDARD DETAIL NO. TS-1121.03

**NOTES:**

1. SPEED HUMPS SHALL NOT BE PLACED OVER MANHOLES, WATER VALVES, SURVEY MARKERS, ETC.
2. SPEED HUMPS SHALL NOT BE INSTALLED IN A LOCATION THAT INTERFERES WITH ROADWAY DRAINAGE.
3. A TACK COAT SHALL BE APPLIED TO THE ROADWAY SURFACE PRIOR TO APPLICATION OF PAVEMENT MATERIAL.
4. SPEED HUMP MARKINGS AND SIGNS SHALL BE INSTALLED BY ACHD, UNLESS OTHERWISE SPECIFIED BY THE ACHD TRAFFIC ENGINEER. MARKING INFORMATION FOR SPEED HUMPS CAN BE FOUND ON ACHD TS-1113.07.
5. "BUMPS AHEAD" SIGNS SHALL BE INSTALLED IN BOTH DIRECTIONS IN ADVANCE OF THE FIRST BUMP IN SERIES. SIGNS SHALL BE INSTALLED BY ACHD, UNLESS OTHERWISE SPECIFIED BY THE ACHD TRAFFIC ENGINEER.
6. IF CURB AND GUTTER IS NOT PRESENT OR A SIGNIFICANT DRIVABLE SHOULDER EXISTS ON THE ROADWAY, 4" DIA. CONCRETE BOLLARD INSTALLATION NEAR EACH SPEED HUMP MAY BE NECESSARY WHERE THE POTENTIAL FOR SPEED HUMP AVOIDANCE EXISTS.

**SPEED HUMP DIMENSION SCHEDULE**

A, ROADWAY WIDTH (FT.)	Y, EDGE (FT.)	Z, HUMP (FT.)	X, GAP (FT.)	ZZ, HUMP (FT.)	X, GAP (FT.)	Z, HUMP (FT.)	Y, EDGE (FT.)
25'	1.5'	6'	2'	6'	2'	6'	1.5'
26'	2'	6'	2'	6'	2'	6'	2'
27'	2.5'	6'	2'	6'	2'	6'	2.5'
28'	3'	6'	2'	6'	2'	6'	3'
29'	2.5'	7'	2'	6'	2'	7'	2.5'
30'	2.5'	7'	2'	7'	2'	7'	2.5'
31'	3'	7'	2'	7'	2'	7'	3'
32'	3'	7'	2'	8'	2'	7'	3'
33'	3'	7.5'	2'	8'	2'	7.5'	3'
34'	3'	7.5'	2.5'	8'	2.5'	7.5'	3'
35'	3'	8'	2.5'	8'	2.5'	8'	3'
36'	3.5'	8'	2.5'	8'	2.5'	8'	3.5'
37'	4'	8'	2.5'	8'	2.5'	8'	4'
38'	4'	8'	3'	8'	3'	8'	4'
39'	4'	8'	3'	9'	3'	8'	4'
40'	4'	8'	3'	10'	3'	8'	4'

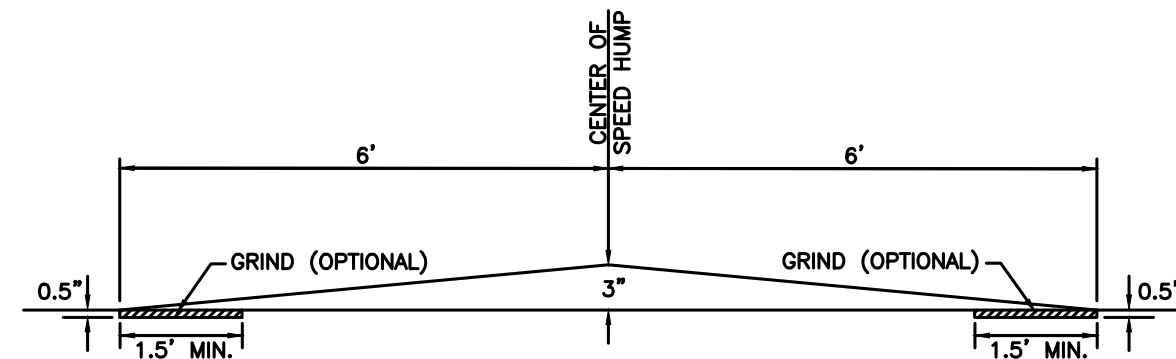
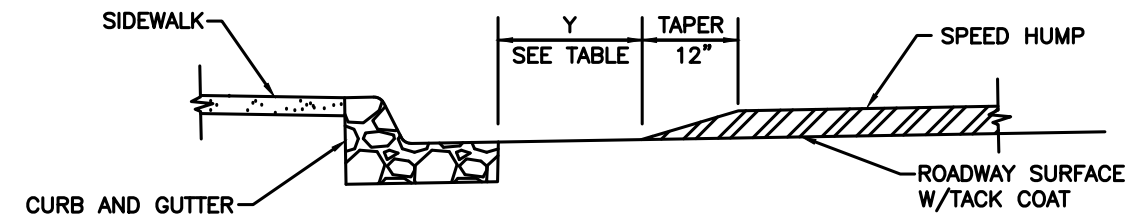
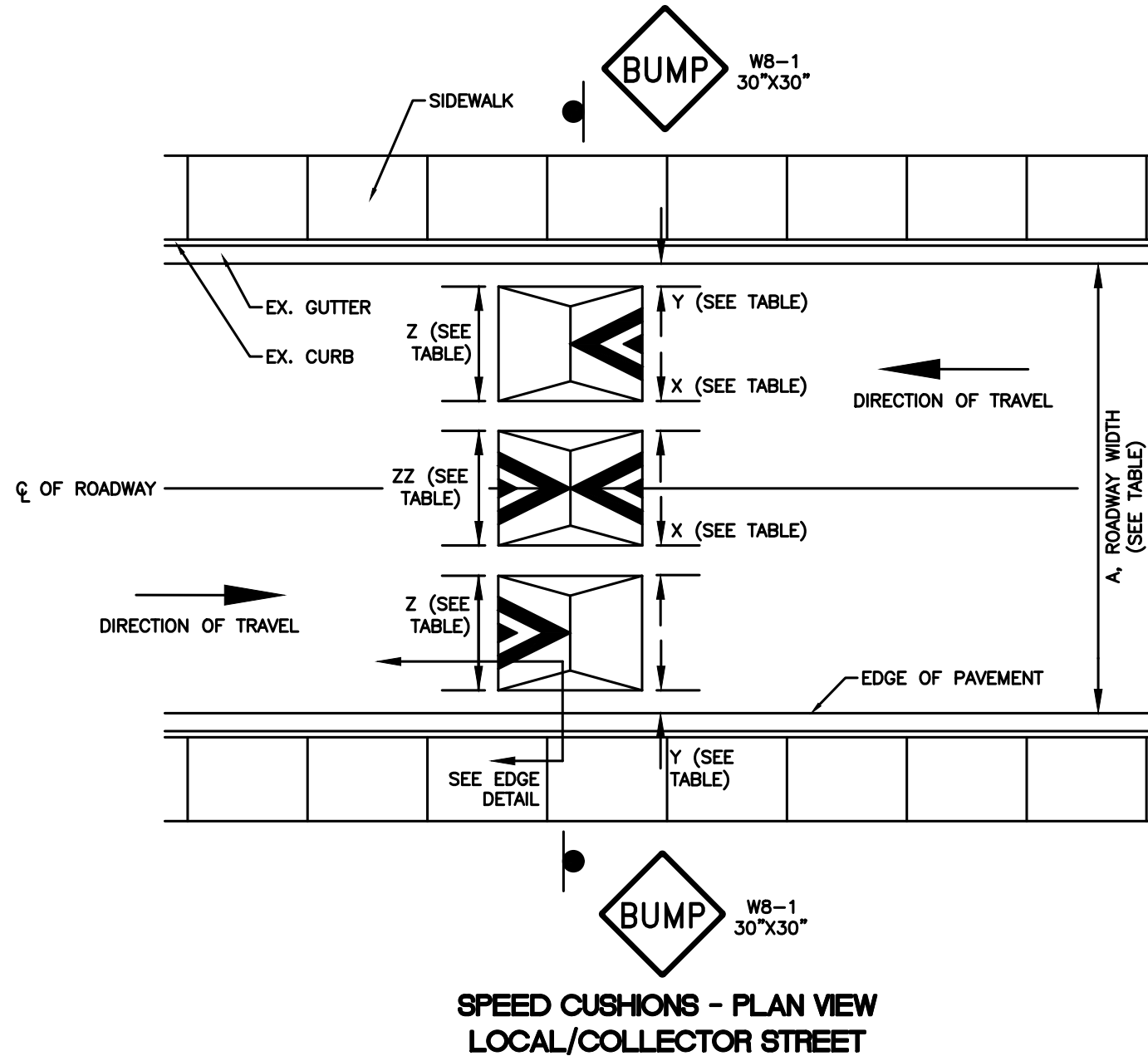

NO.	DATE	BY	DESCRIPTION
• REVISIONS •			

**ACHD**  
Traffic Engineering Division  
3775 Adams Street Boise, ID 83714  
www.achdidaho.org

• SIGNATURES •	
Scale: NTS	Drawn By: Joshua Seak
Date: 4/13/2012	Design By: Joshua Seak
File: TS-1121.04.DWG	Approved By: Shawn Martin

• SHEET TITLE •	
Speed Hump Details - Local/Collector Streets, Speed Cushions Roadway Cross Sections, 25' - 40'	

PROFESSIONAL ENGINEER  
REGISTERED  
12842  
STATE OF IDAHO  
JOSHUA SEAK  
STANDARD DETAIL NO. TS-1121.04

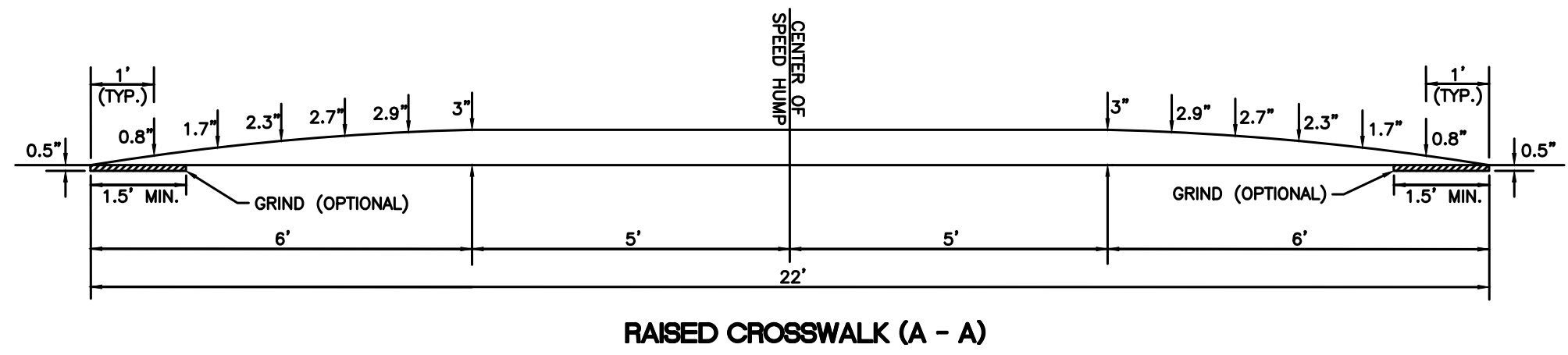
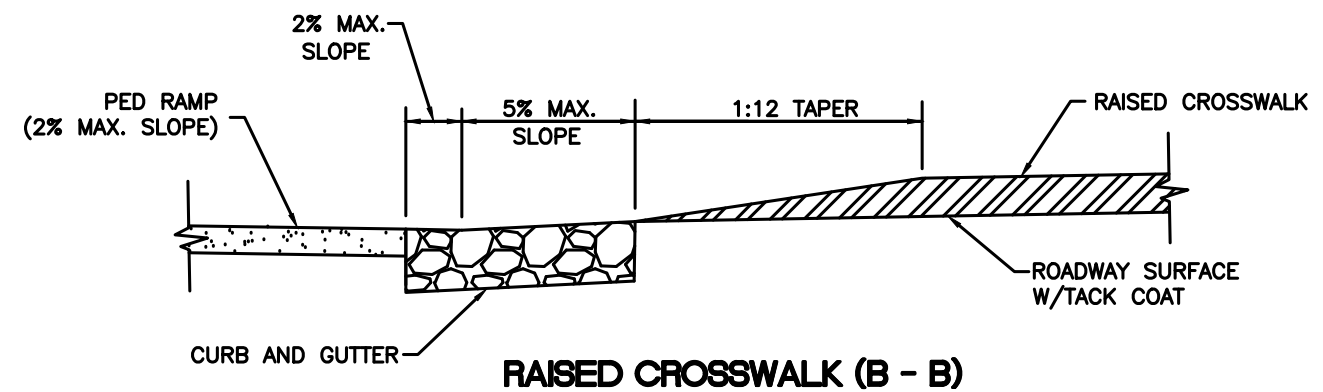
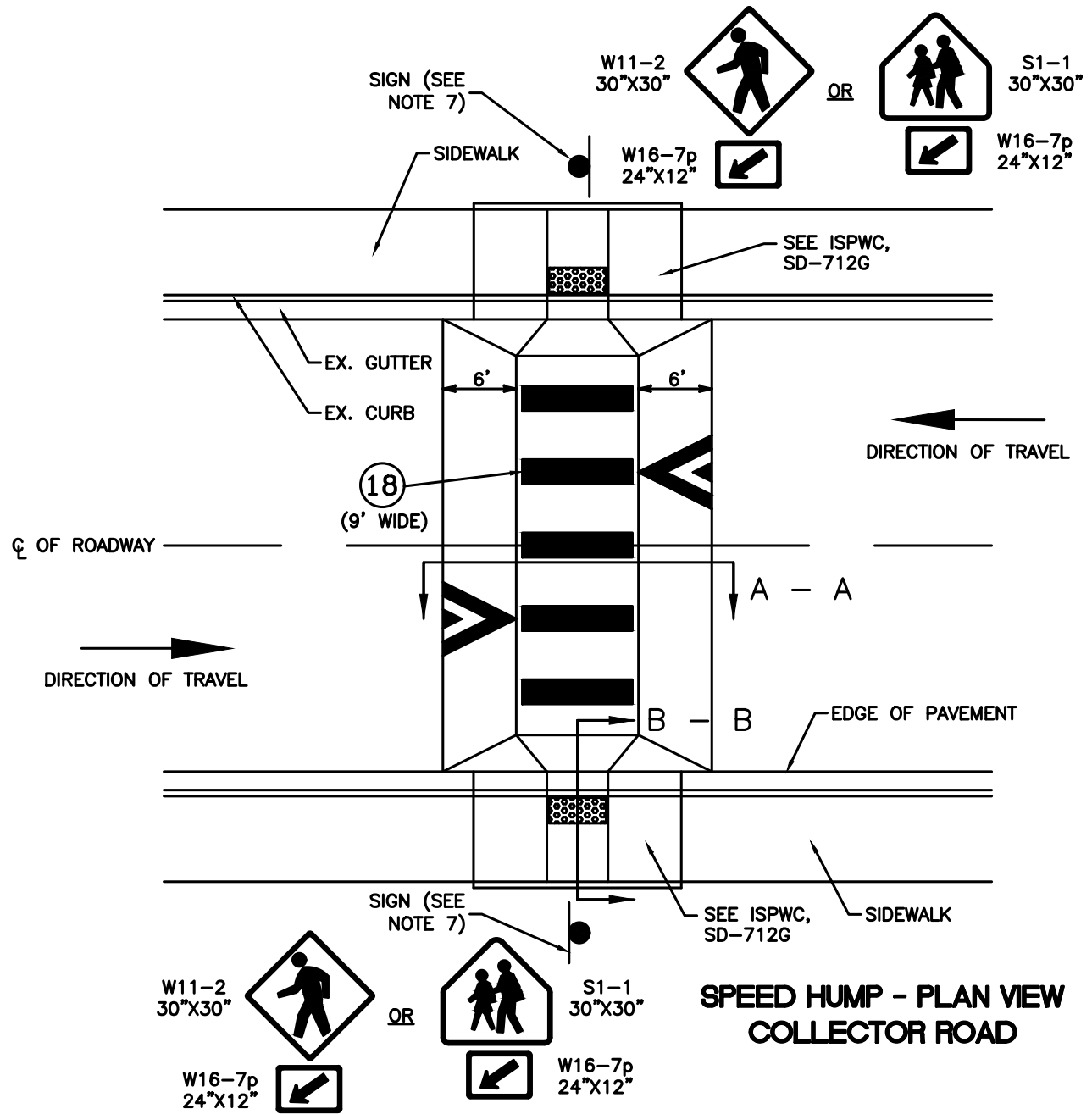

- NOTES:**
1. SPEED HUMPS SHALL NOT BE PLACED OVER MANHOLES, WATER VALVES, SURVEY MARKERS, ETC.
  2. SPEED HUMPS SHALL NOT BE INSTALLED IN A LOCATION THAT INTERFERES WITH ROADWAY DRAINAGE.
  3. A TACK COAT SHALL BE APPLIED TO THE ROADWAY SURFACE PRIOR TO APPLICATION OF PAVEMENT MATERIAL.
  4. SPEED HUMP MARKINGS AND SIGNS SHALL BE INSTALLED BY ACHD, UNLESS OTHERWISE SPECIFIED BY THE ACHD TRAFFIC ENGINEER. MARKING INFORMATION FOR SPEED HUMPS CAN BE FOUND ON ACHD TS-1113.07.
  5. "BUMPS AHEAD" SIGNS SHALL BE INSTALLED IN BOTH DIRECTIONS IN ADVANCE OF THE FIRST BUMP IN SERIES. SIGNS SHALL BE INSTALLED BY ACHD, UNLESS OTHERWISE SPECIFIED BY THE ACHD TRAFFIC ENGINEER.
  6. ALL PEDESTRIAN RAMPS SHALL CONFORM TO THE MOST RECENT VERSION OF THE ISPWC.
  7. SIGNS ADJACENT TO THE RAISED CROSSWALK SHALL BE INSTALLED ACCORDING TO ACHD TS-1114.01. REFER TO THE PLAN SHEETS OR CONTACT THE ACHD TRAFFIC ENGINEER FOR THE TYPE OF SIGN TO BE INSTALLED.

NO.	DATE	BY	DESCRIPTION
11/2018	JES		Minor signage modifications

• REVISIONS •



• SIGNATURES •		• SHEET TITLE •	
Scale: NTS	Drawn By: Joshua Seak	Raised Crosswalk Details	
Date: 11/01/2018	Design By: Joshua Seak		
File: TS-1121.06.DWG	Approved By: Shawn Martin		

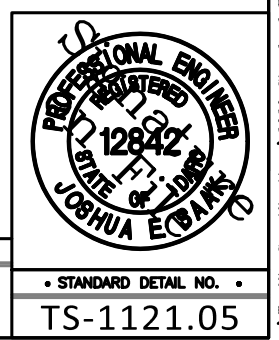

# TRAFFIC CALMING MINIMUM STREET LENGTH ELIGIBILITY

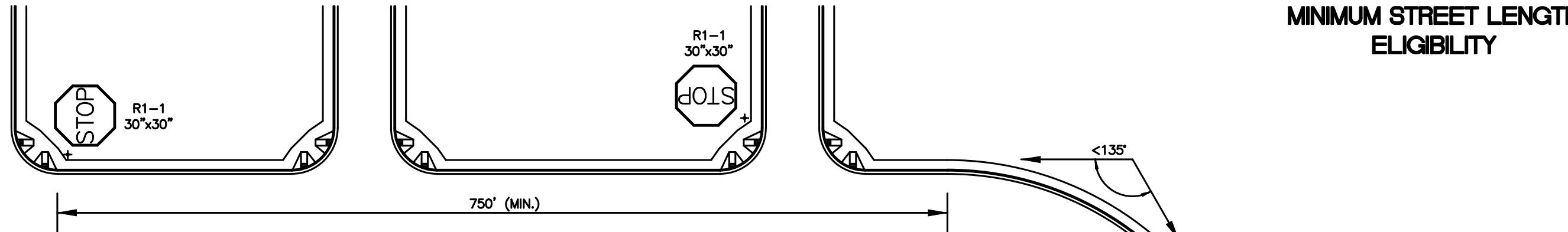

**FIGURE 1**

**NOTES:**

1. FIGURE 1 SHOWS THE MINIMUM LENGTH (750') NECESSARY TO BE ELIGIBLE FOR TRAFFIC CALMING ON STREETS WITH HORIZONTAL CURVES. THE DISTANCE SHOULD BE MEASURED FROM THE RADIUS RETURN OF THE START OF TRAFFIC CALMING TO THE START OF A CURVE WITH A DEFLECTION GREATER THAN 45 DEGREES.
2. FIGURE 2 SHOWS THE MINIMUM LENGTH (750') NECESSARY TO BE ELIGIBLE FOR TRAFFIC CALMING ON LINEAR STREETS CONTROLLED INTERSECTIONS. THE DISTANCE SHOULD BE MEASURED FROM THE RADIUS RETURN OF THE START OF TRAFFIC CALMING TO THE RADIUS RETURN OF THE END OF TRAFFIC CALMING.

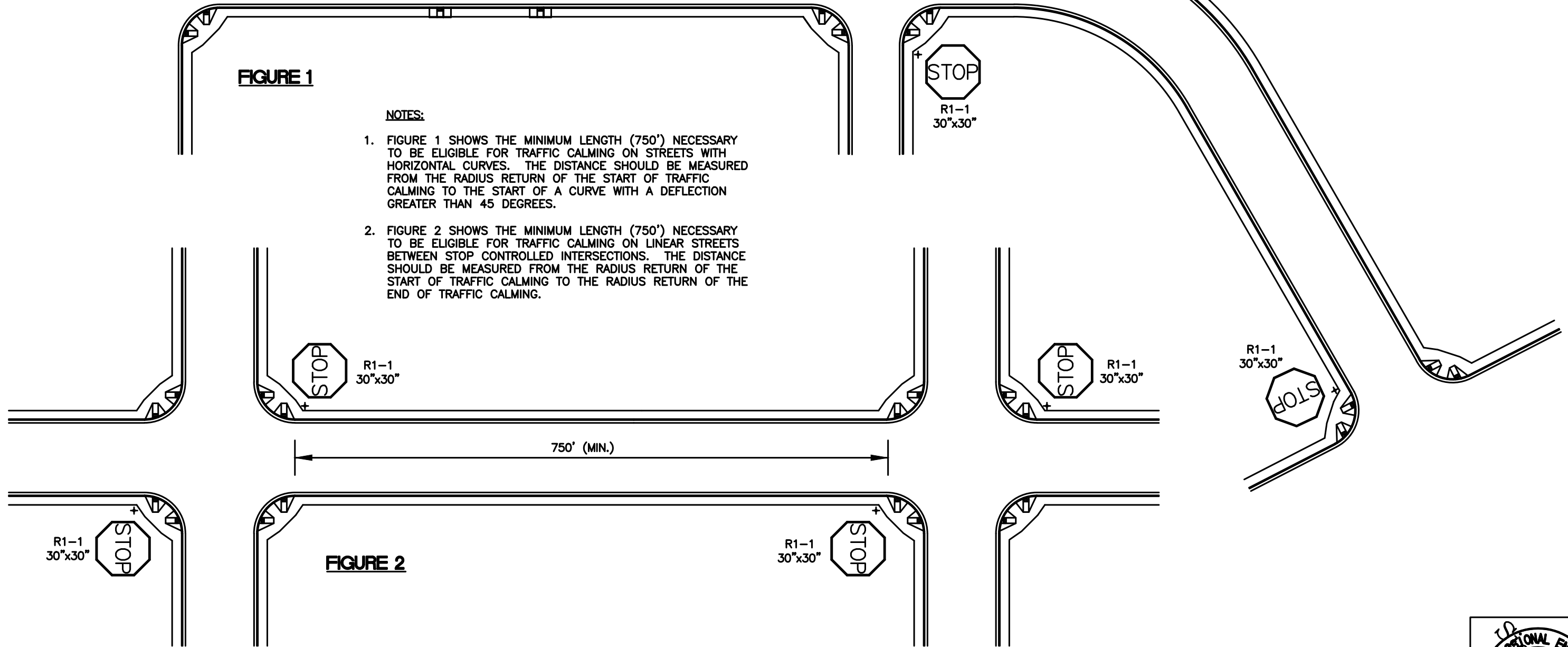

**FIGURE 2**

NO.	DATE	BY	DESCRIPTION
• REVISIONS •			



Traffic Engineering Division  
3775 Adams Street Boise, ID 83714  
www.achdidaho.org

Scale: NTS  
Date: 12/27/2013  
File: TS-1121.06.DWG

• SIGNATURES •

Drawn By: Joshua Saak  
Design By: Joshua Saak  
Approved By: Shawn Martin

• SHEET TITLE •

Traffic Calming –  
Minimum Street Length

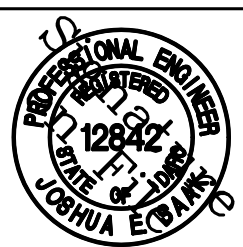

• STANDARD DETAIL NO. •  
TS-1121.06